

# MARTY THE ROBOT

—— Build Guide ——



# WHERE TO START!

**Robot Kit** - Step 1

**Partly-assembled Kit** - Step 25

**Assembled Robot** - Ready to Code

## TOP TIPS

- Get help from an adult if you're under 14.
- Pay attention to the part orientation.
- Try not to trap or squish the cables.
- Check you have all the parts.
- Be gentle with the motors.
- Do the steps in order.
- Have fun!

**Top Tip:** Use the Marty App or our online support for extra help & tips.

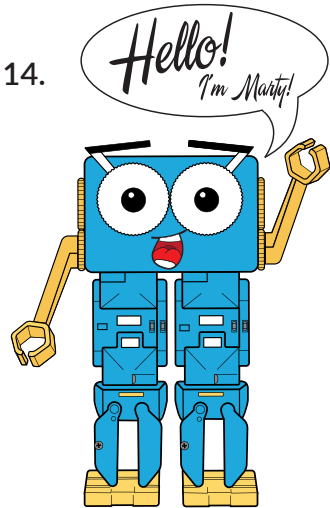

## SCREW GUIDE

When you see an icon like this **A** use the **SCREW GUIDE** below to select the correct screw.



1-L

LEFT LEG



x 1



x 1

**ROBOTICAL**  
13#-001\_1060  
Left Hip Servo

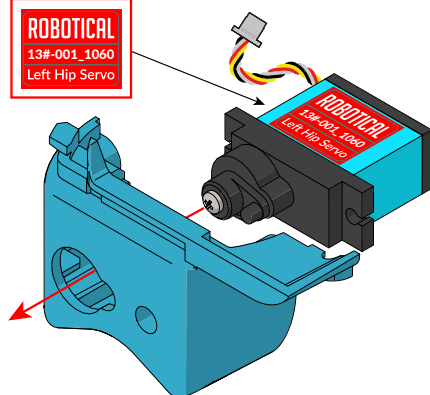

Twist 90°

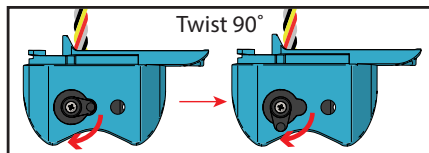

1-R

RIGHT LEG



x 1



x 1

**ROBOTICAL**  
13#-001\_1063  
Right Hip Servo

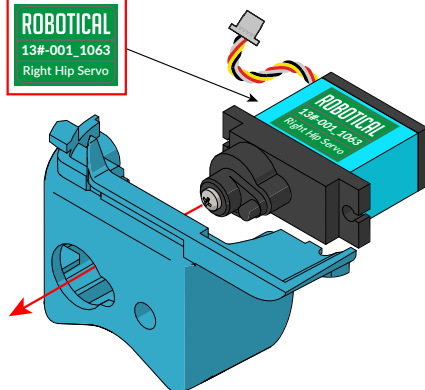

Twist 90°

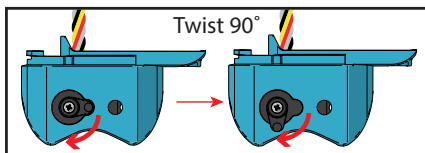

2-L

LEFT LEG



x 1



x 1

**ROBOTICAL**  
13#-001\_1062  
Left Knee Servo

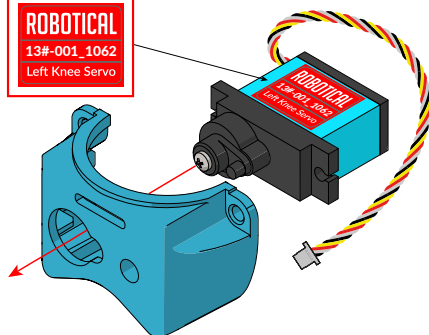

Twist 90°

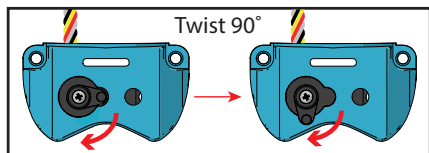

2-R

RIGHT LEG



x 1



x 1

**ROBOTICAL**  
13#-001\_1065  
Right Knee Servo

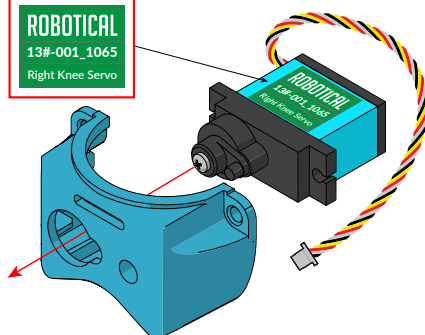

Twist 90°

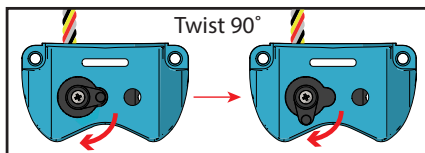



3-L

LEFT LEG



x1



x1



x1



x1

A

Refer to the  
**SCREW GUIDE**  
on first page

A

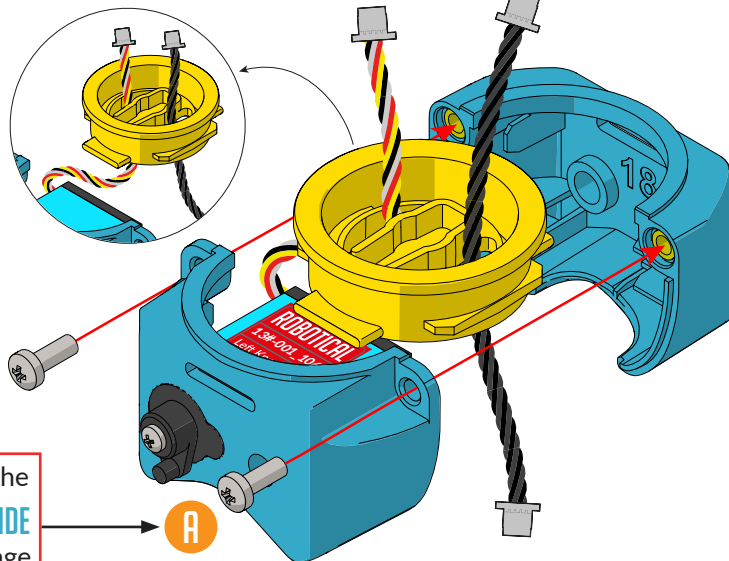

3-R

RIGHT LEG



x1



x1



x1



x1

A

A

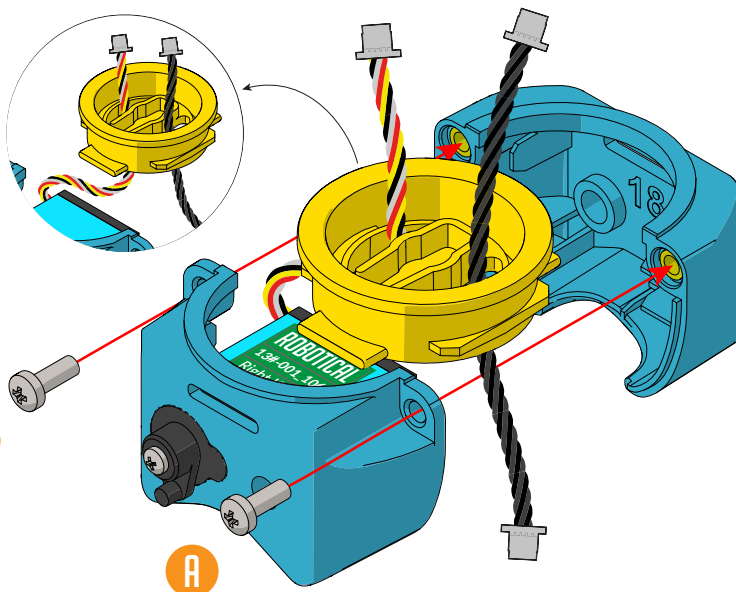

**4-L**  
LEFT LEG

-  x 1
-  x 1

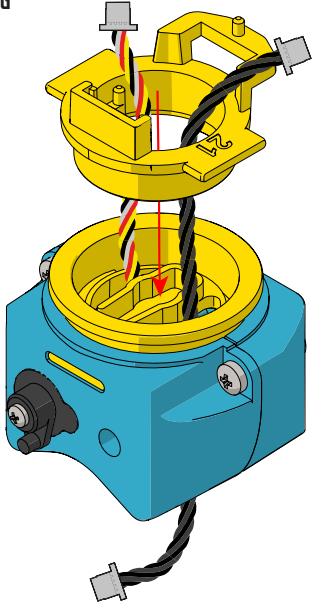

**4-R**  
RIGHT LEG

-  x 1
-  x 1

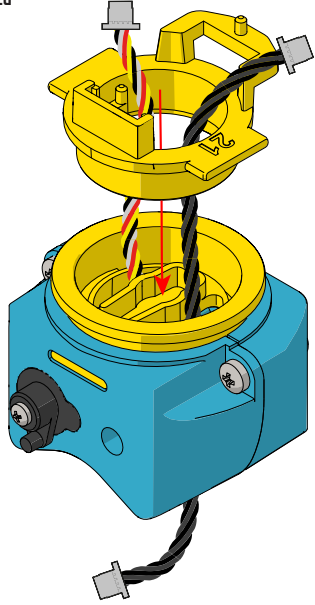

**5-L**  
LEFT LEG

-  x 1
-  x 1

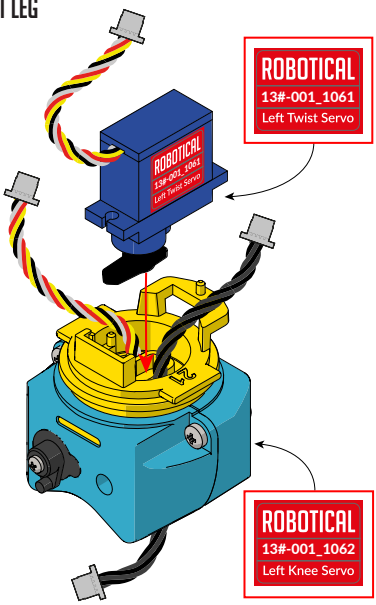

**5-R**  
RIGHT LEG

-  x 1
-  x 1

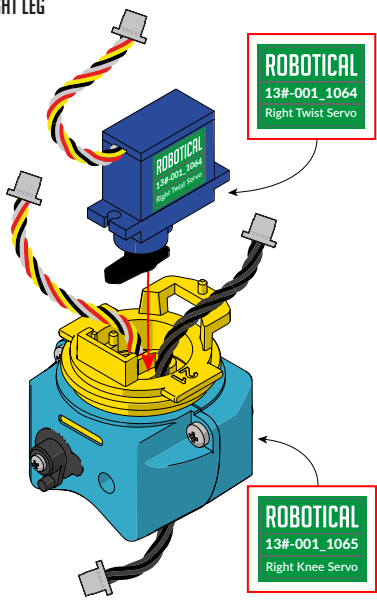

**6-L**  
LEFT LEG



x 1



x 1



x 1

 Cables must look like this

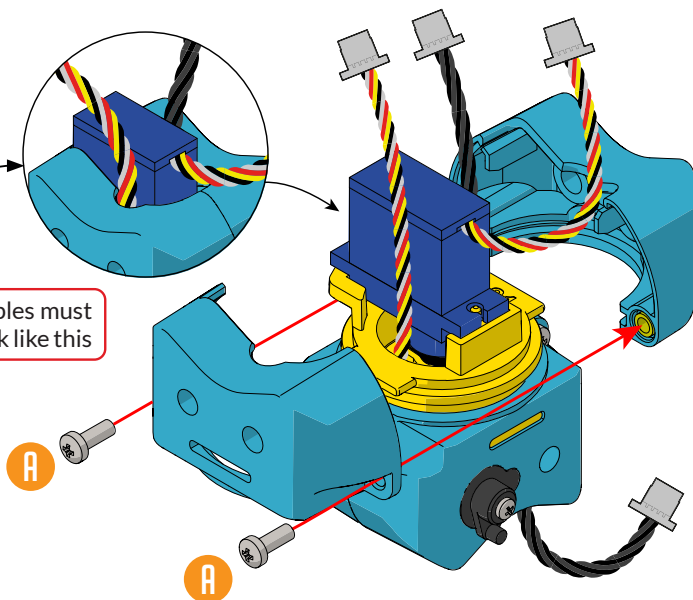

**6-R**  
RIGHT LEG



x 1



x 1



x 1

 Cables must look like this

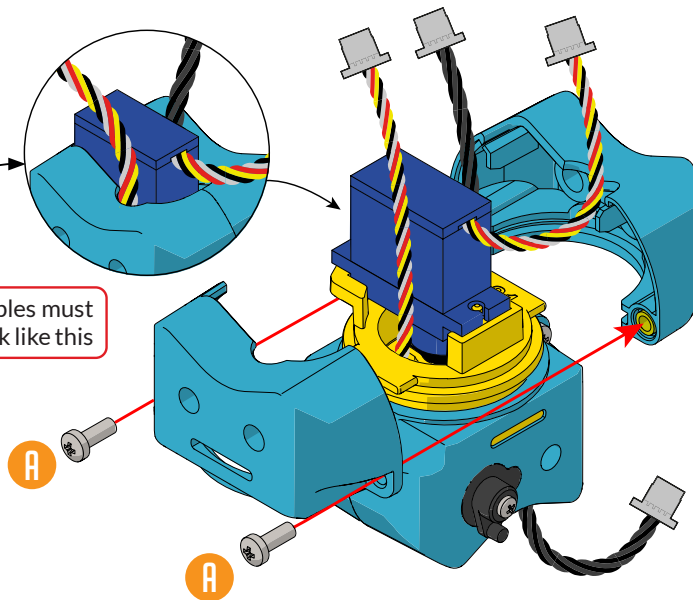

7

BOTH LEGS

 x 2     x 4

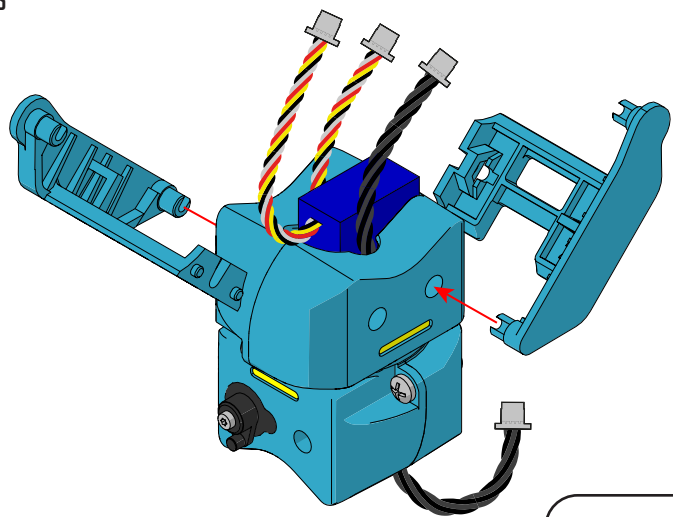

Build 2



8

BOTH LEGS

 x 2

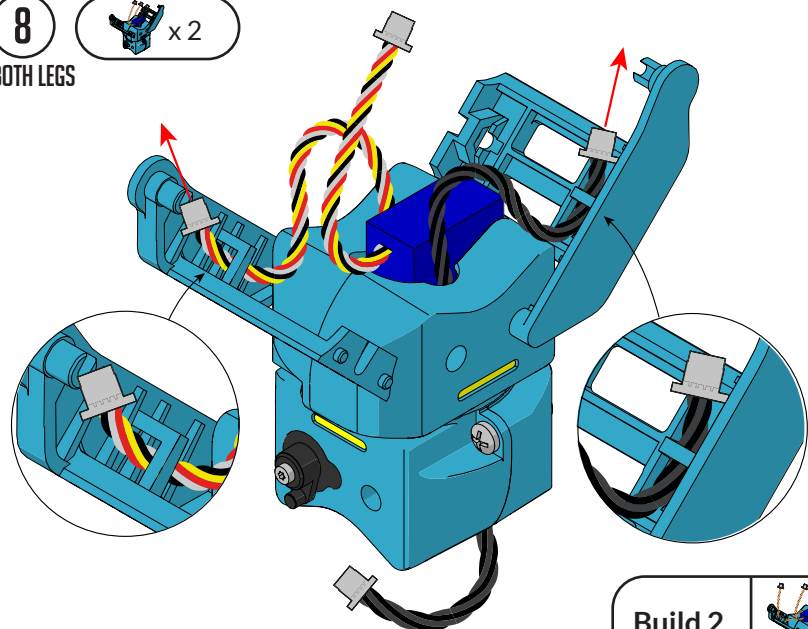

Build 2



9

BOTH LEGS

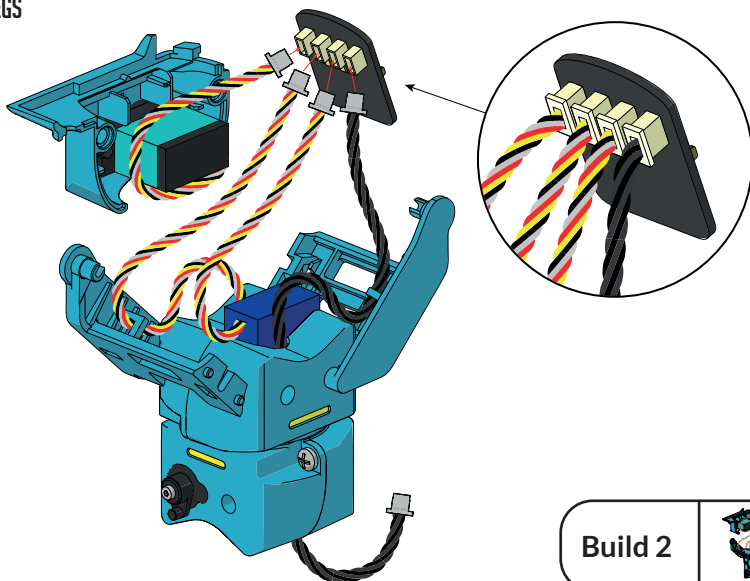

Build 2



10

BOTH LEGS

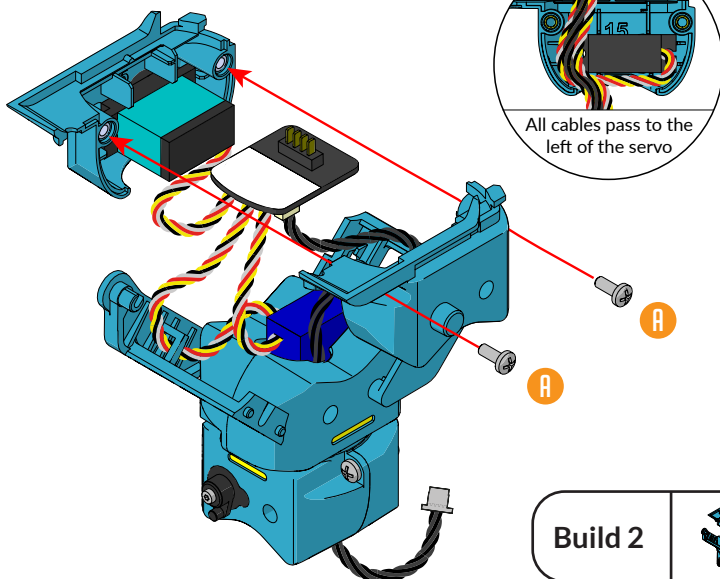

All cables pass to the left of the servo

Build 2



11



x 2

BOTH LEGS

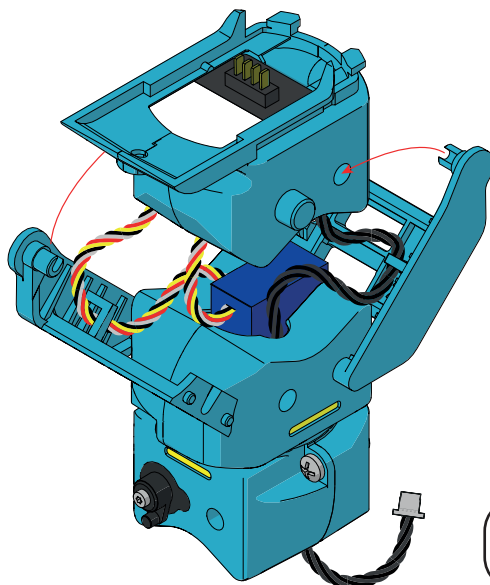

Build 2



12



x 2



x 2

BOTH LEGS

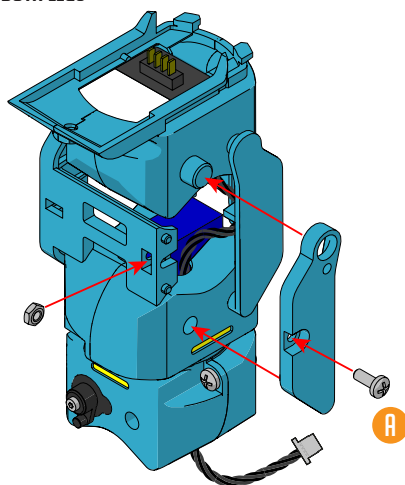

Build 2



13



x 2



x 2

BOTH LEGS

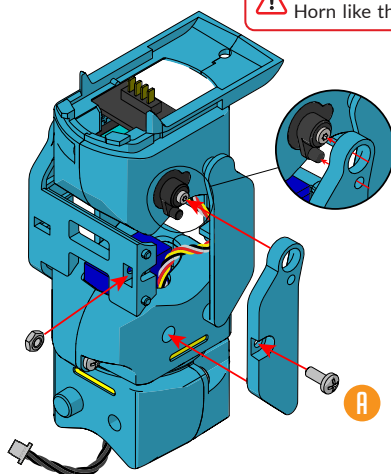



⚠ Engage Servo  
Horn like this

Build 2



14

 x 2     x 2

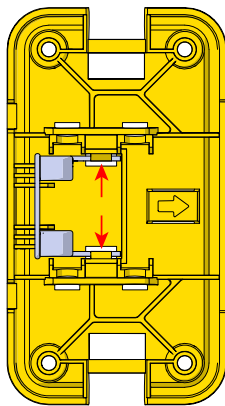
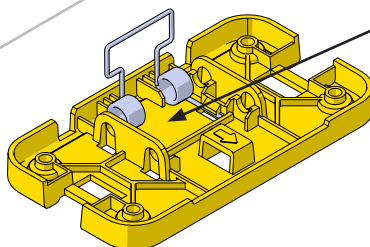
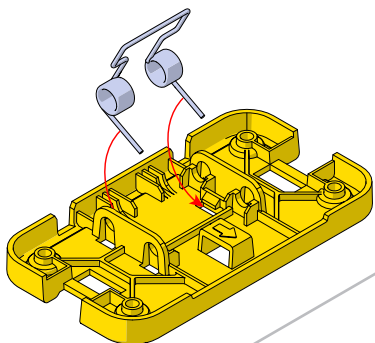

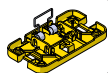

After assembly,  
secure the spring  
legs under the lips.

Build 2 feet



15

LEFT LEG

 x 1     x 1     x 1

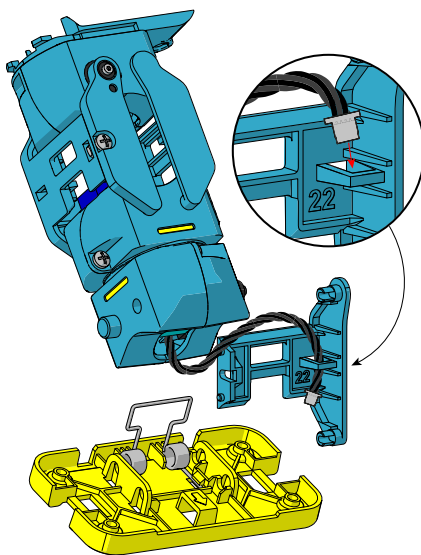

16

LEFT LEG

 x 1

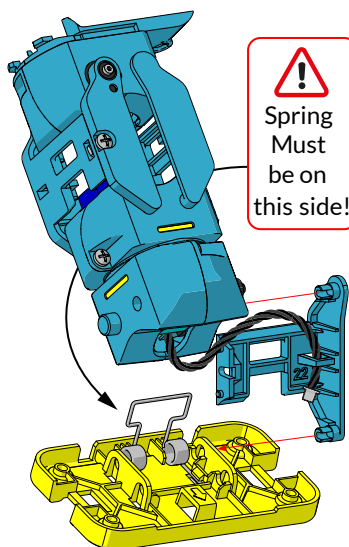

  
Spring  
Must  
be on  
this side!

17

LEFT LEG

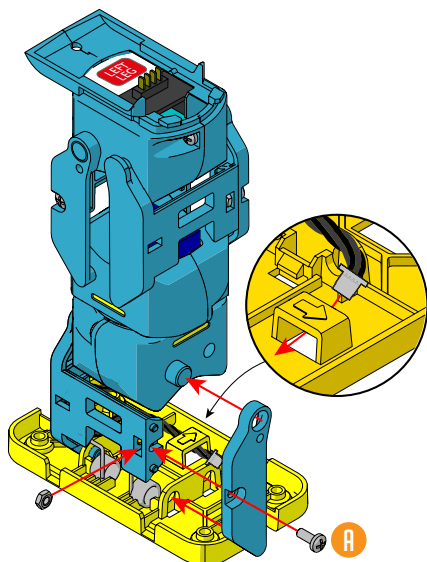
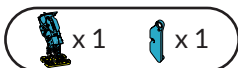

18

LEFT LEG

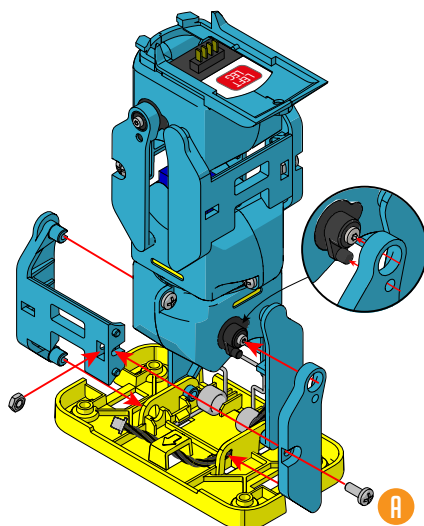
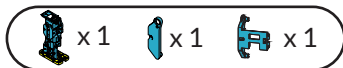

19

LEFT LEG

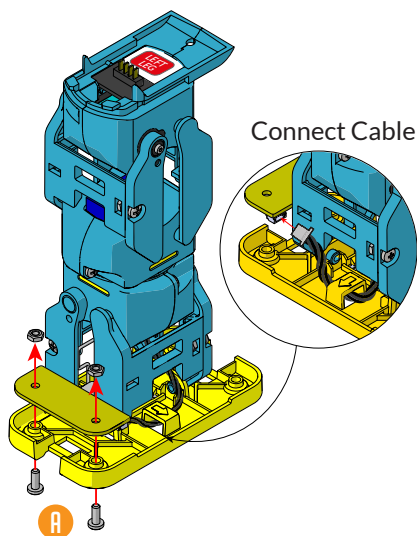
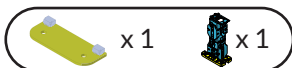

20

RIGHT LEG

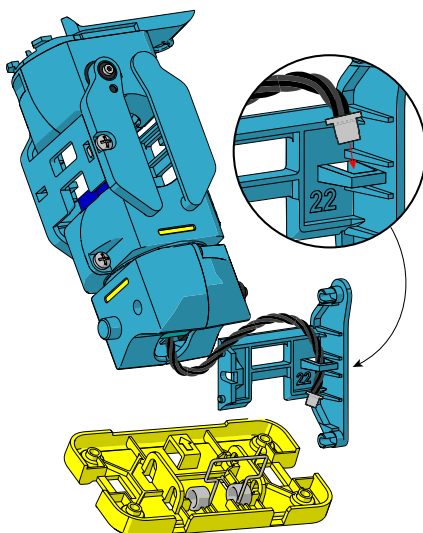
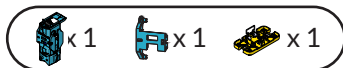



21

RIGHT LEG

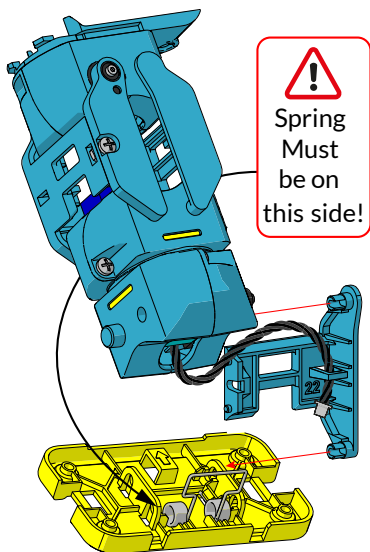
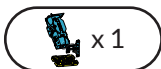

22

RIGHT LEG

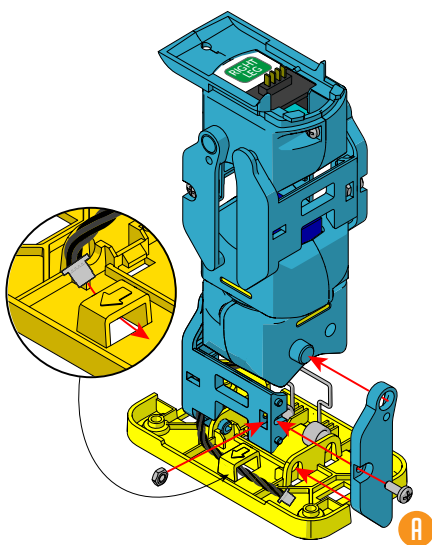
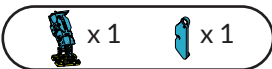

23

RIGHT LEG

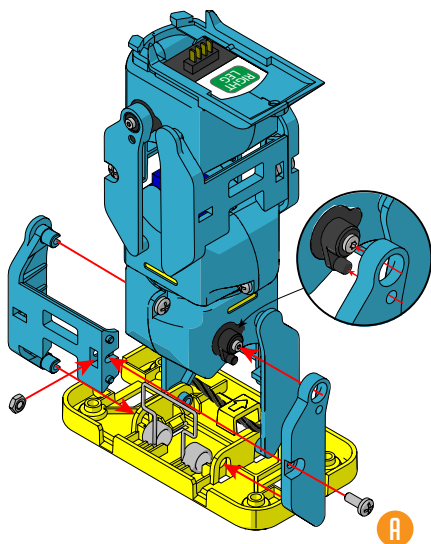
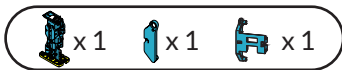

24

RIGHT LEG

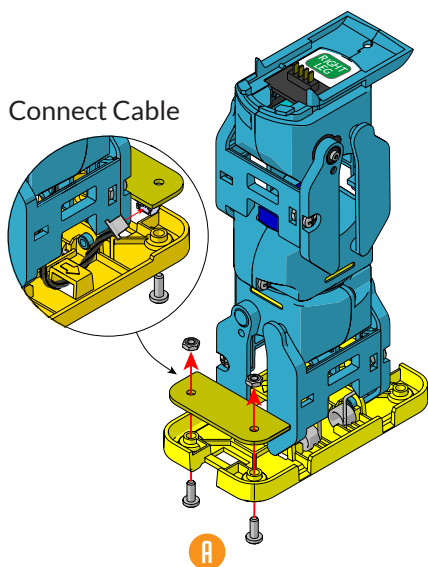
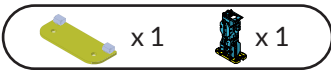

25-L

LEFT ARM



x 1



x 1

**ROBOTICAL**  
13#-001\_1066  
Left Arm Servo

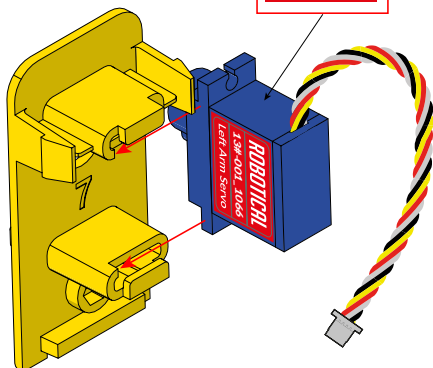

25-R

RIGHT ARM



x 1



x 1

**ROBOTICAL**  
130-001\_1067  
Right Arm Servo

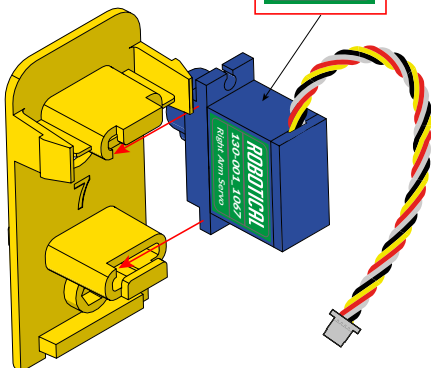

26



x 2



x 2

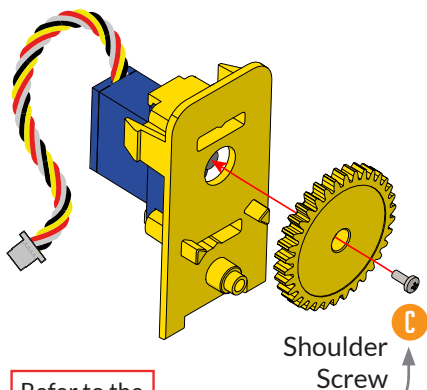

Refer to the  
**SCREW GUIDE**  
on first page

Build both arms



27



x 2



x 2



x 2

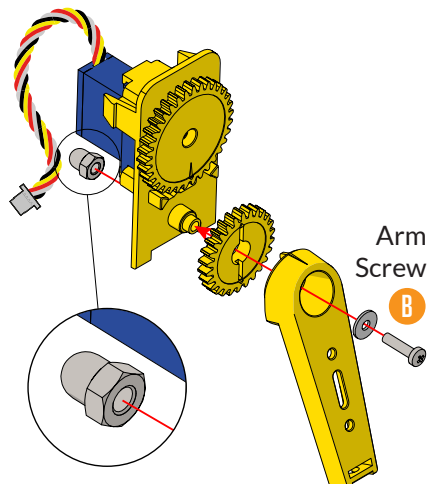

Arm  
Screw

**B**

Build both arms



28



x 2



x 2

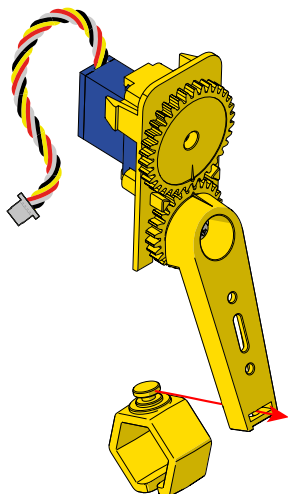

Build both arms



29



x 1



x 1

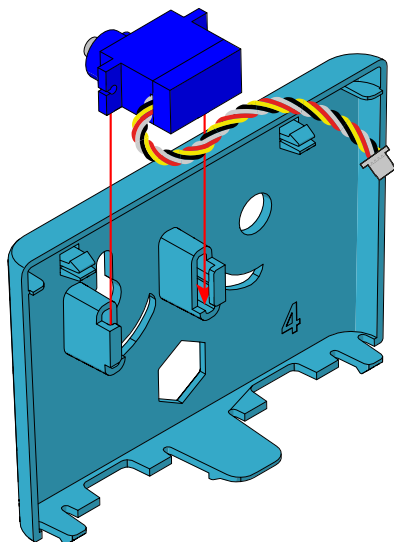

30



x 1



x 1

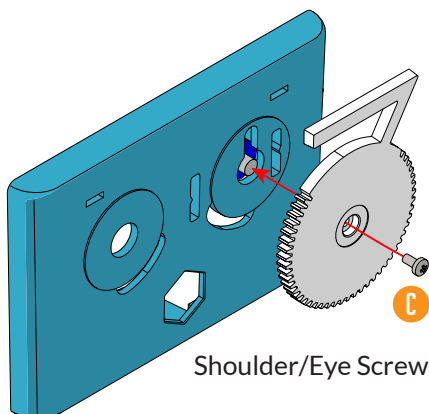

31



x 1



x 1



x 1

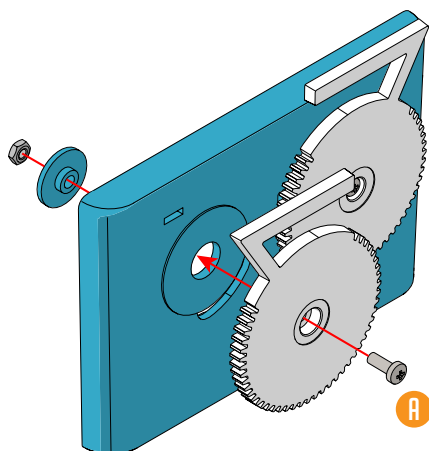

32



x 1



x 1

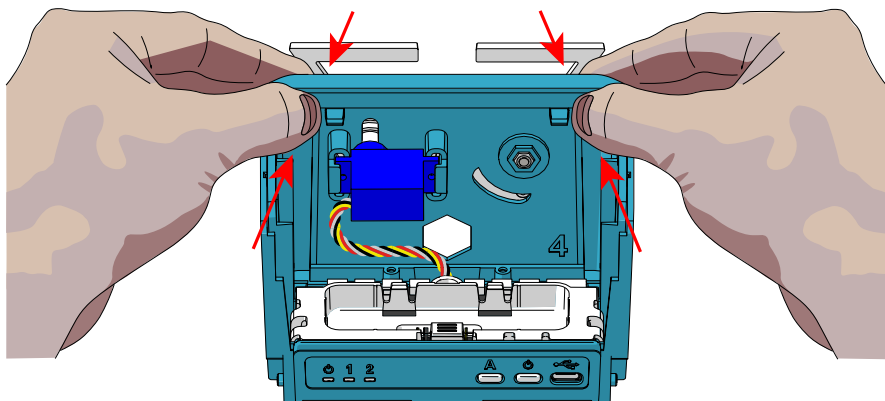
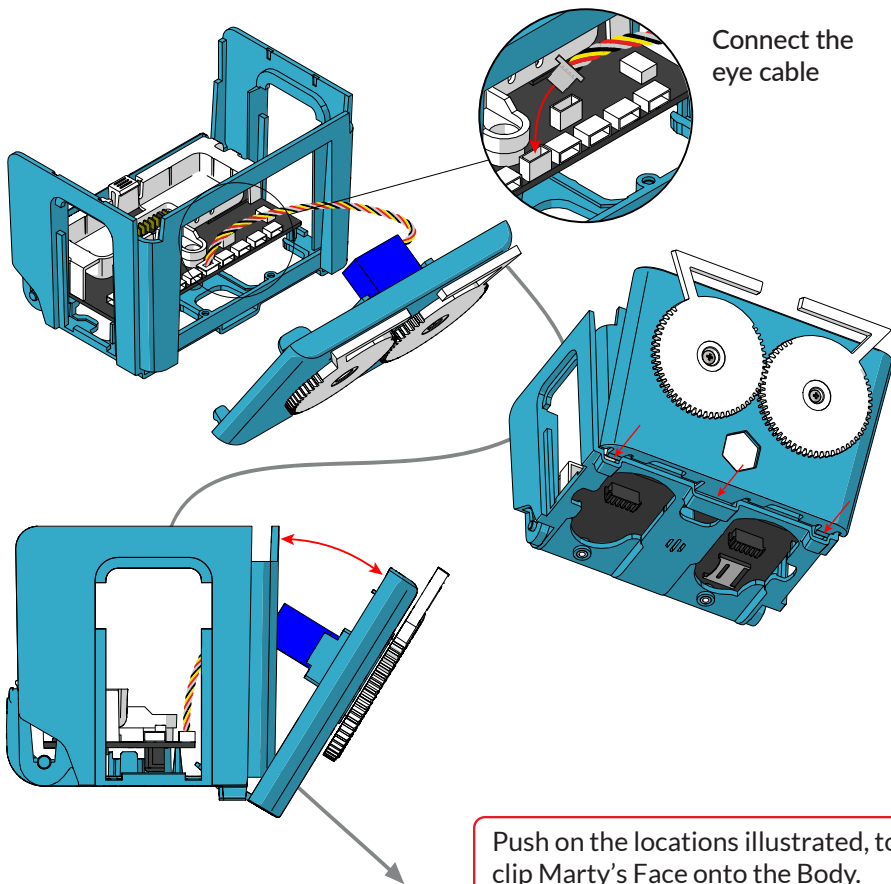

33



x 1



x 1

ATTACH **RIGHT** LEG TO THE BODY

**RIGHT  
LEG**



Attached the leg as illustrated below. Pay attention to the position of the cable to highlight orientation.

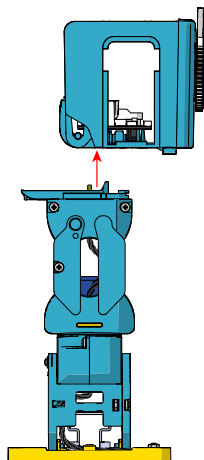

Step 1

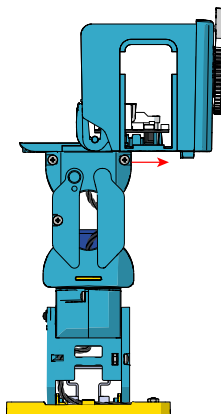

Step 2

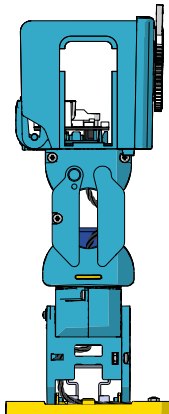

Step 3

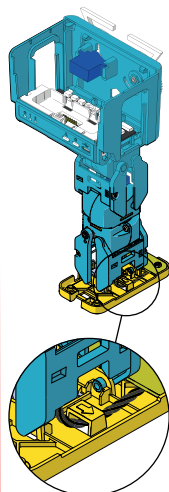

34



x 1



x 1

ATTACH **LEFT** LEG TO THE BODY

**LEFT  
LEG**



Attached the leg as illustrated below. Pay attention to the position of the cable to highlight orientation.

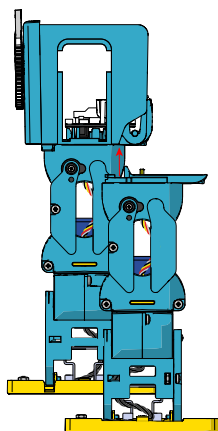

Step 1

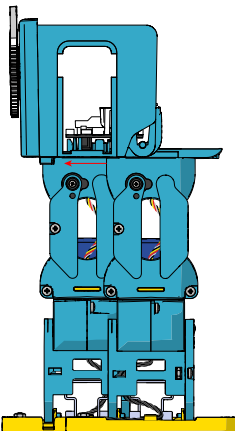

Step 2

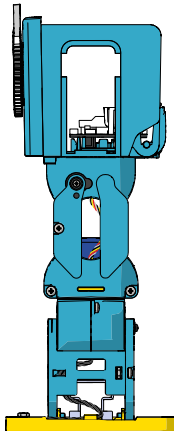

Step 3

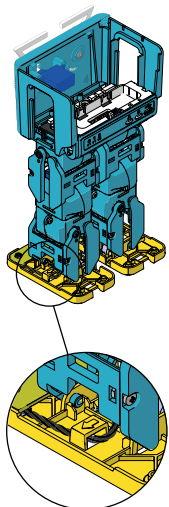

35

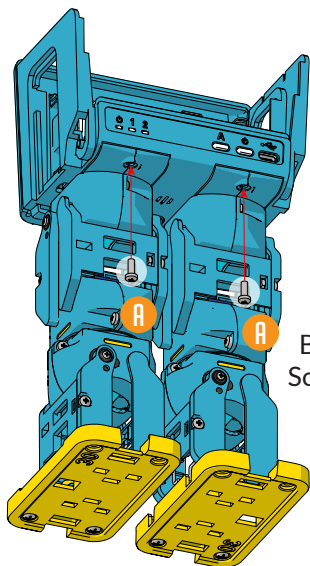

Body  
Screw

36



CONNECT THE ARM CABLES

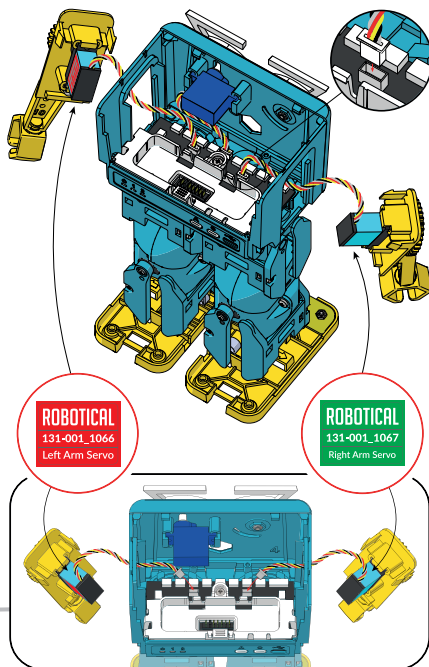

Clip the arms into the body

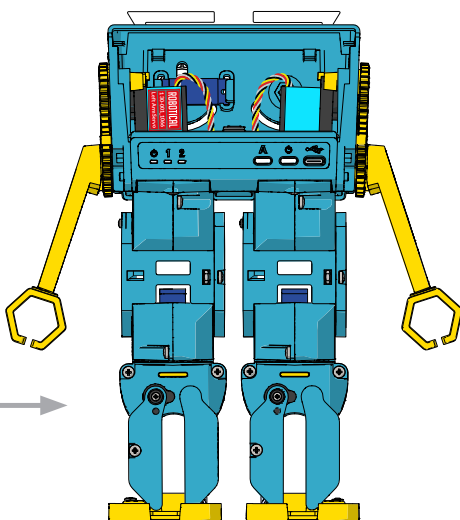
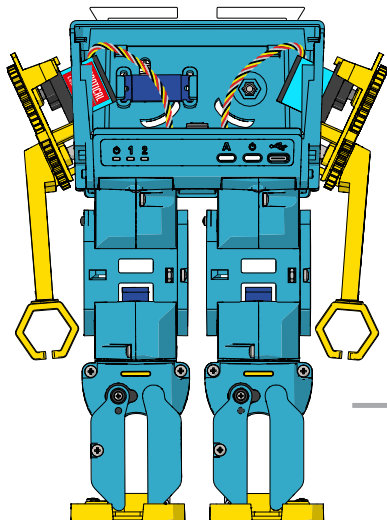

37



x 1



x 1

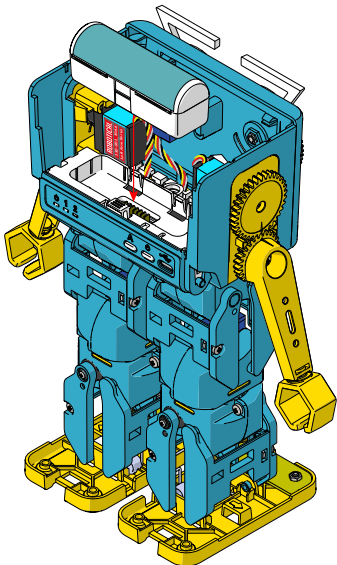

38



x 1



x 1

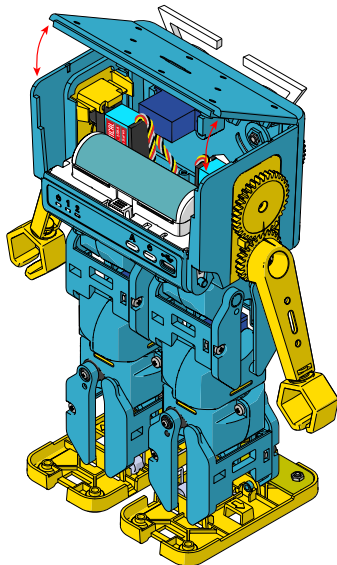

39



x 1



x 1

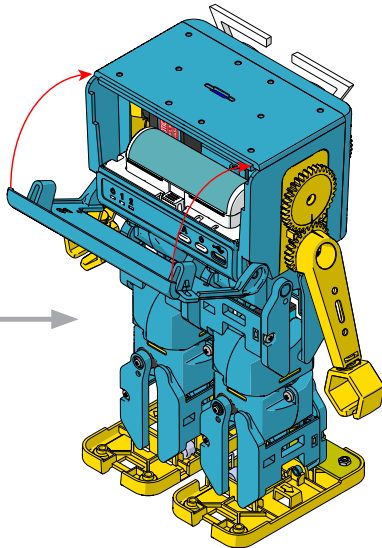
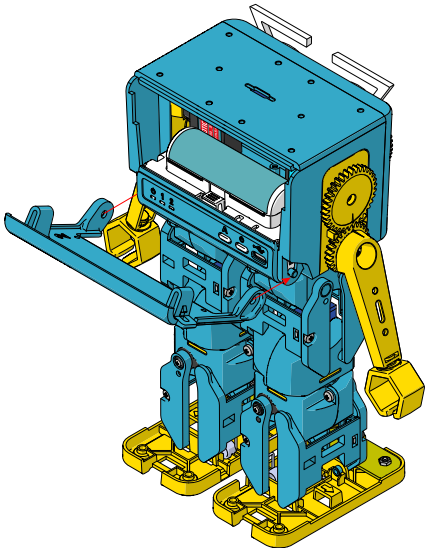

40



x 1 Sticker Sheet

Personalise your Marty!

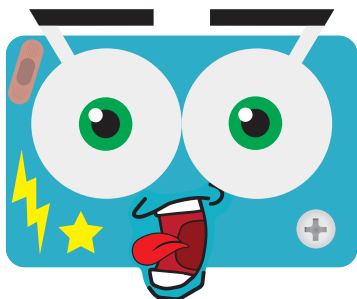
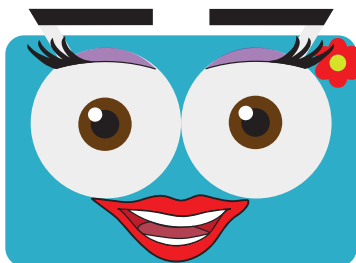
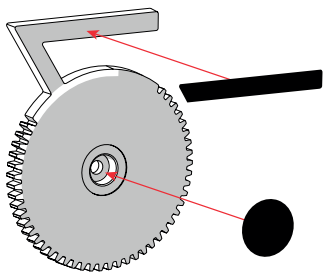

## NEXT STEPS

You have now finished building your Marty

To set-up your Marty and start coding,  
download the Marty the Robot App  
and follow the on screen instructions

