

# MARTY the ROBOT

## Build Guide



# Where to Start!

**Robot Kit** - Step 1

**Partly-assembled Kit** - Step 25

**Assembled Robot** - Ready to Code

## TOP TIPS

- Get help from an adult if you're under 14.
- Pay attention to the part orientation.
- Try not to trap or squish the cables.
- Check you have all the parts.
- Be gentle with the motors.
- Do the steps in order.
- Have fun!

Top Tip: Use the Marty App or our online support for extra help & tips.

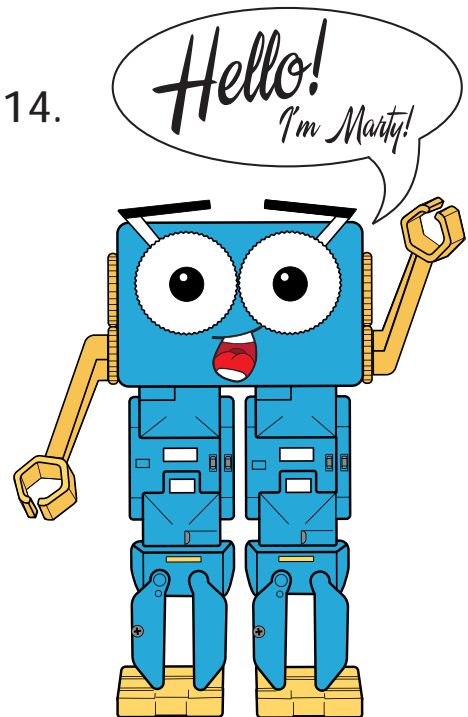

## Screw Guide

When you see an icon like this  use the **SCREW GUIDE** below to select the correct screw.



1-l

Left Leg



x 1



x 1

**ROBOTICAL**

13#-001\_1060

Left Hip Servo

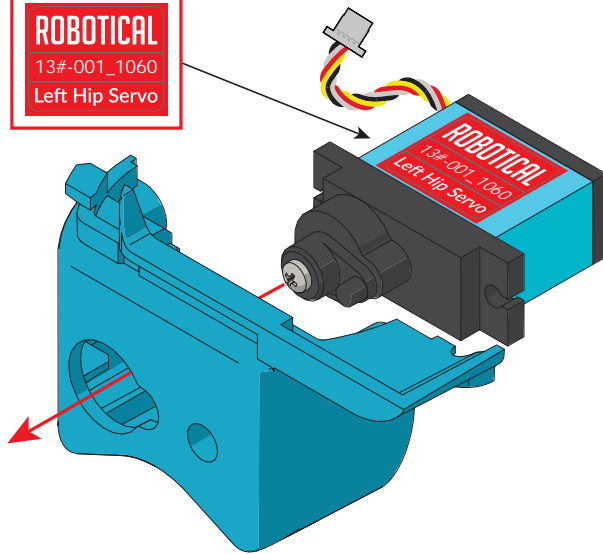

Twist 90°

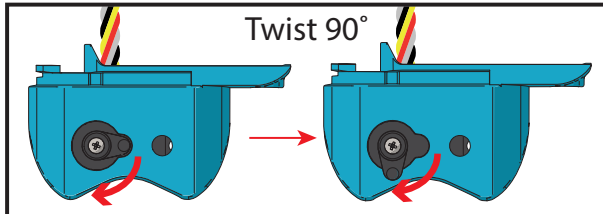

1-r

right Leg



x 1



x 1

**ROBOTICAL**

13#-001\_1063

Right Hip Servo

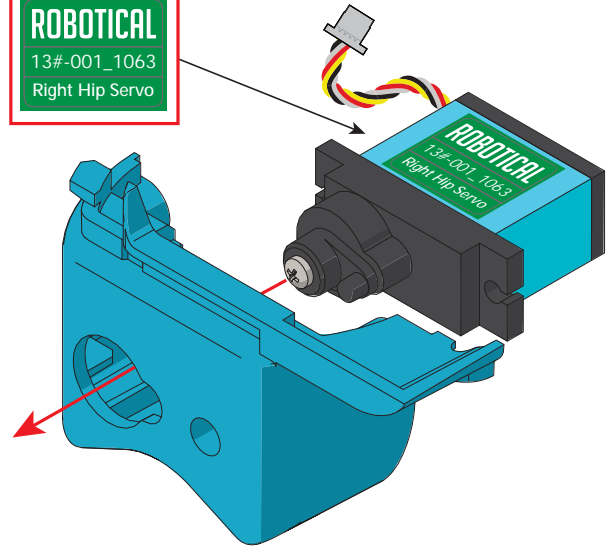

Twist 90°

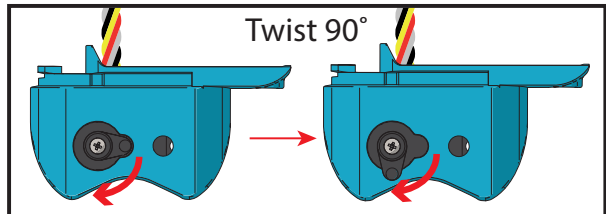

2-l

Left Leg



x 1



x 1

**ROBOTICAL**

13#-001\_1062

Left Knee Servo

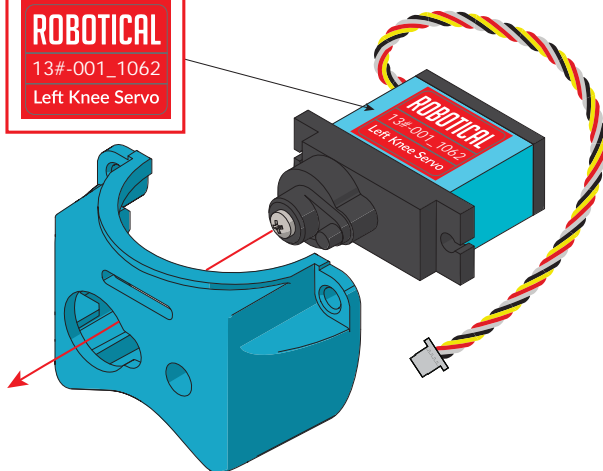

Twist 90°

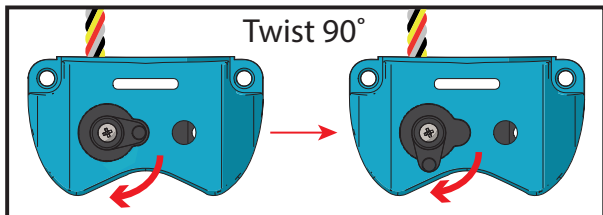

2-r

right Leg



x 1



x 1

**ROBOTICAL**

13#-001\_1065

Right Knee Servo

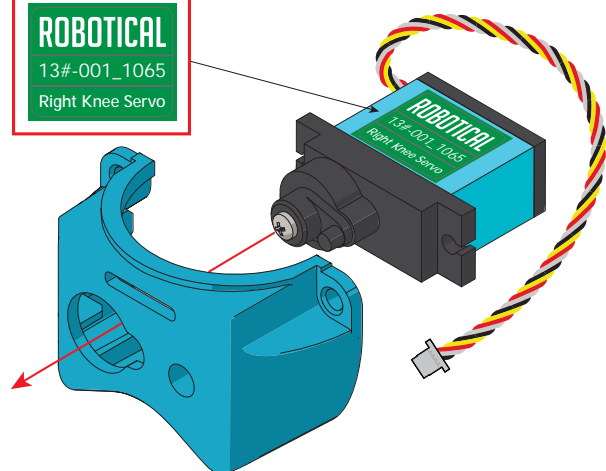

Twist 90°

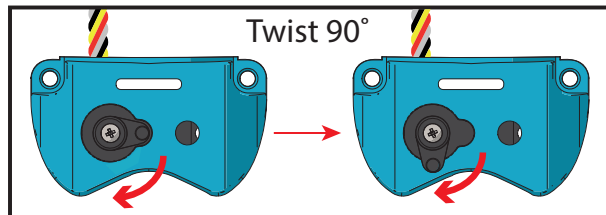

3-l

Left Leg

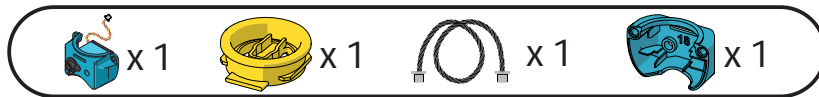

Refer to the  
**Screw Guide**  
on first page

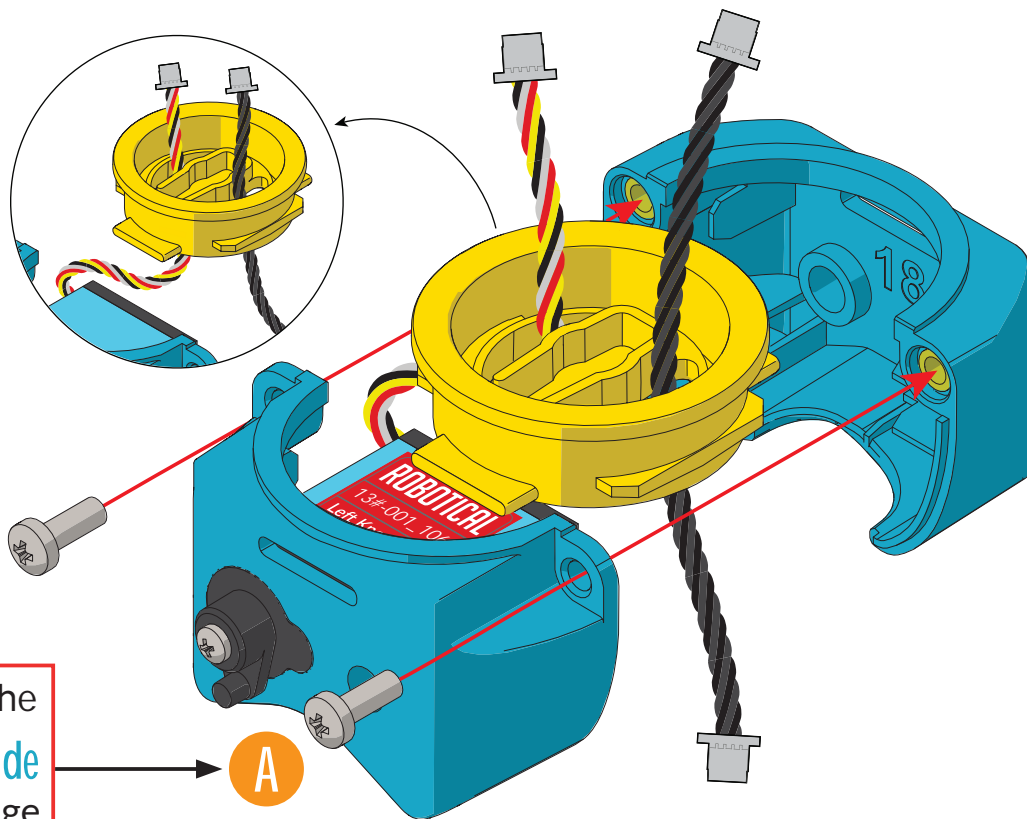

3-r

right Leg

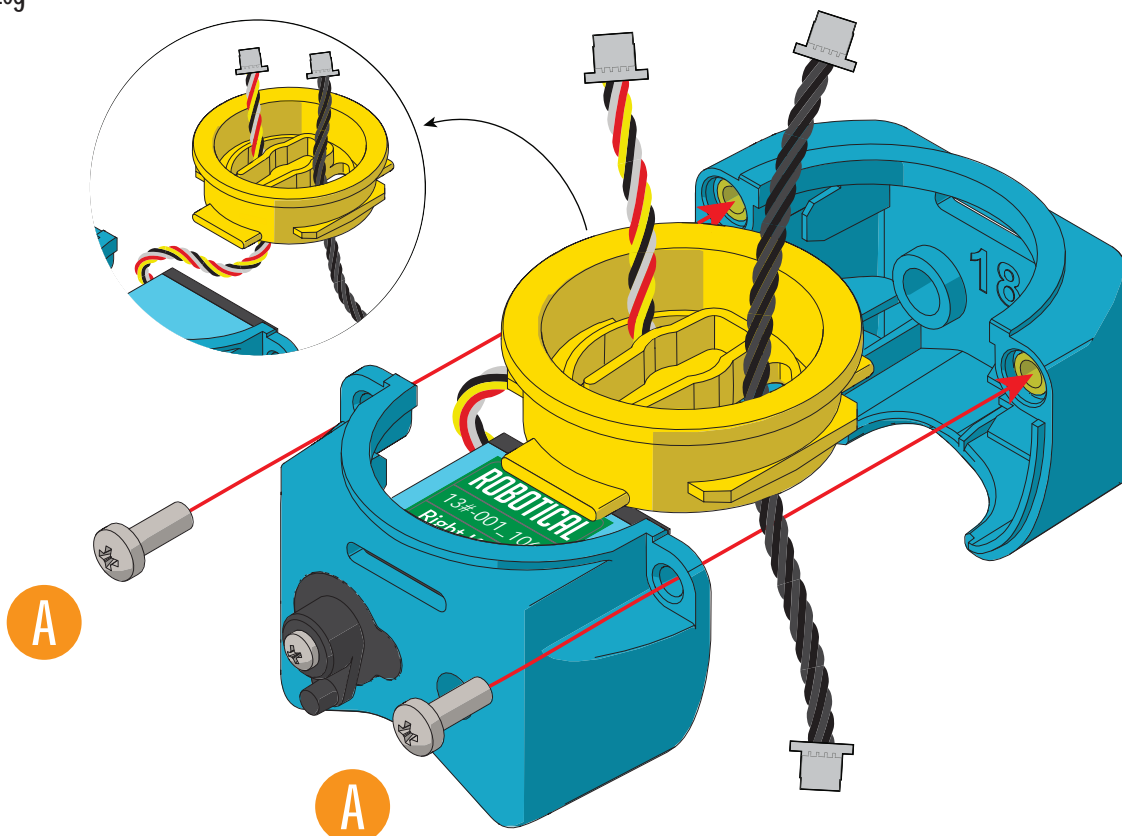
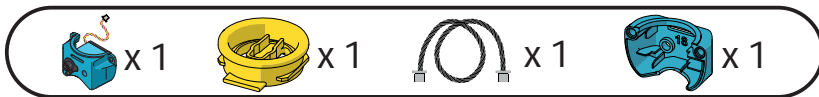

4-l

Left Leg

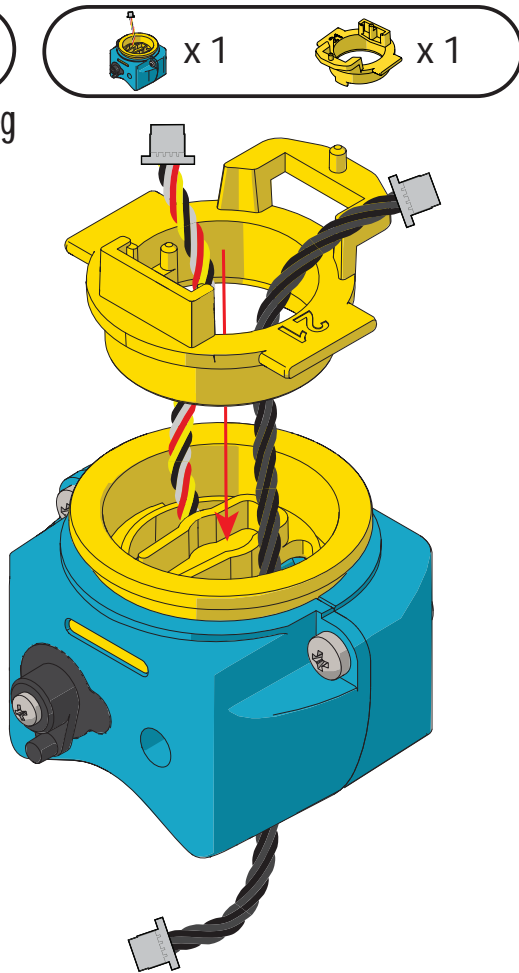

4-r

right Leg

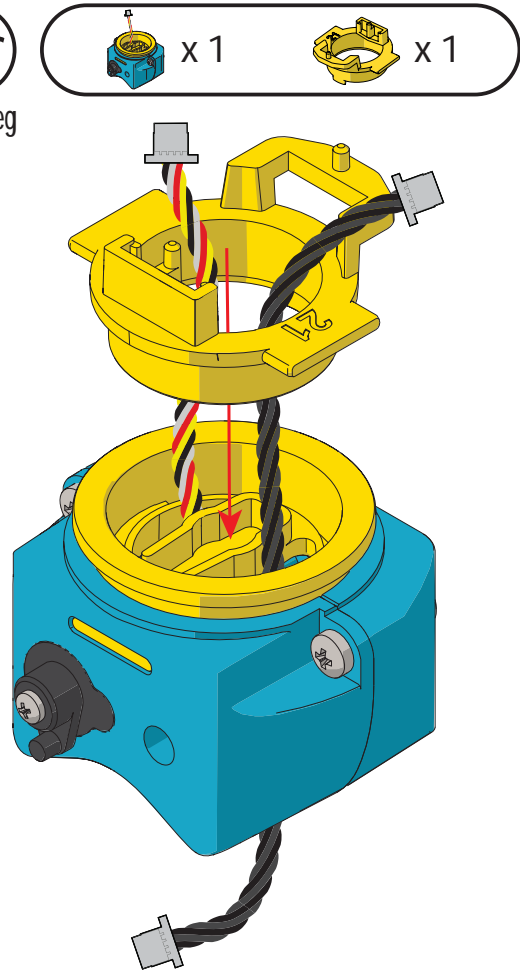

5-L

Left Leg

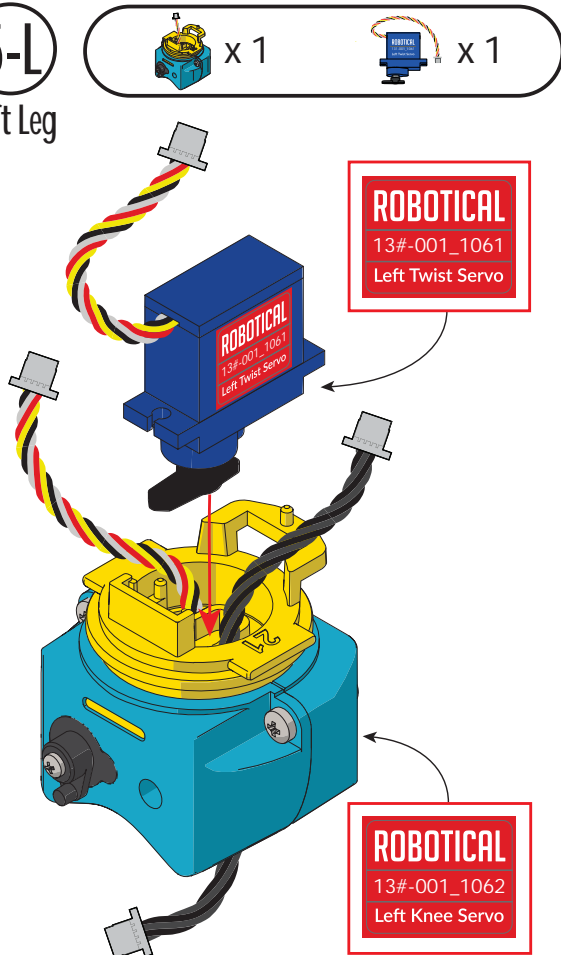

5-R

right Leg

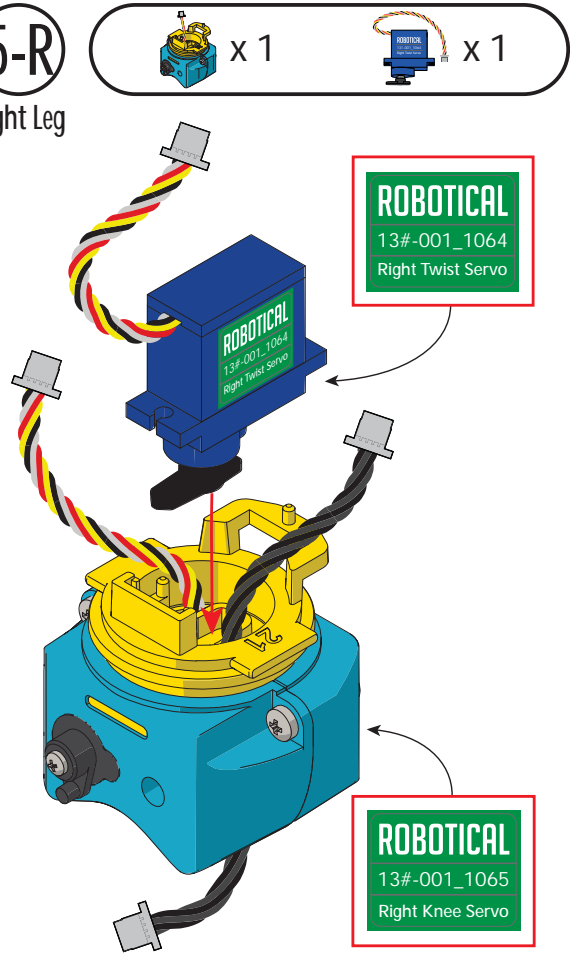

6-l

Left Leg



x 1



x 1



x 1



Cables must look like this

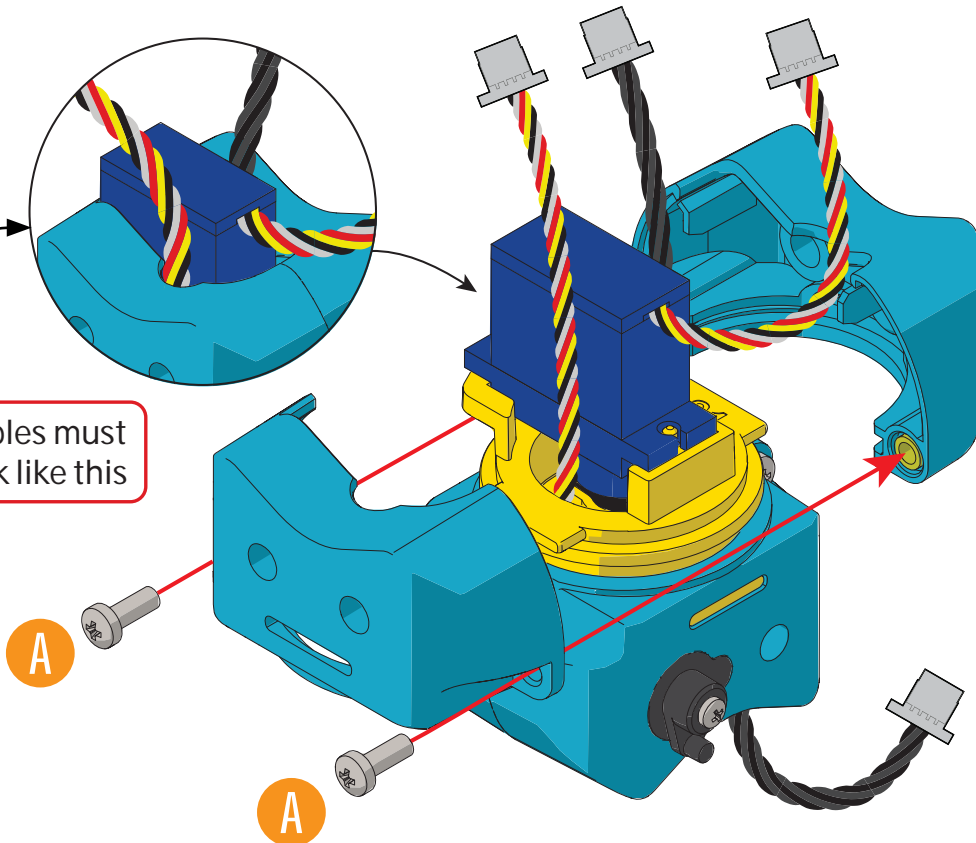

6-r

right Leg



x 1



x 1



x 1



Cables must look like this

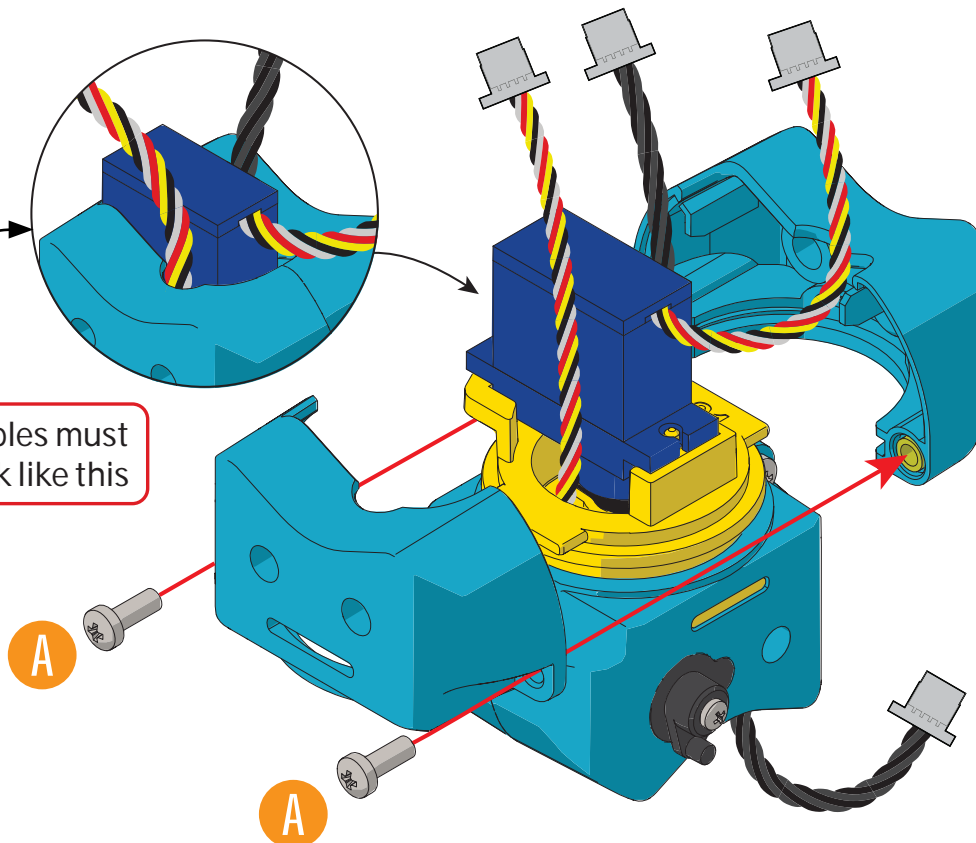

7

Both Legs

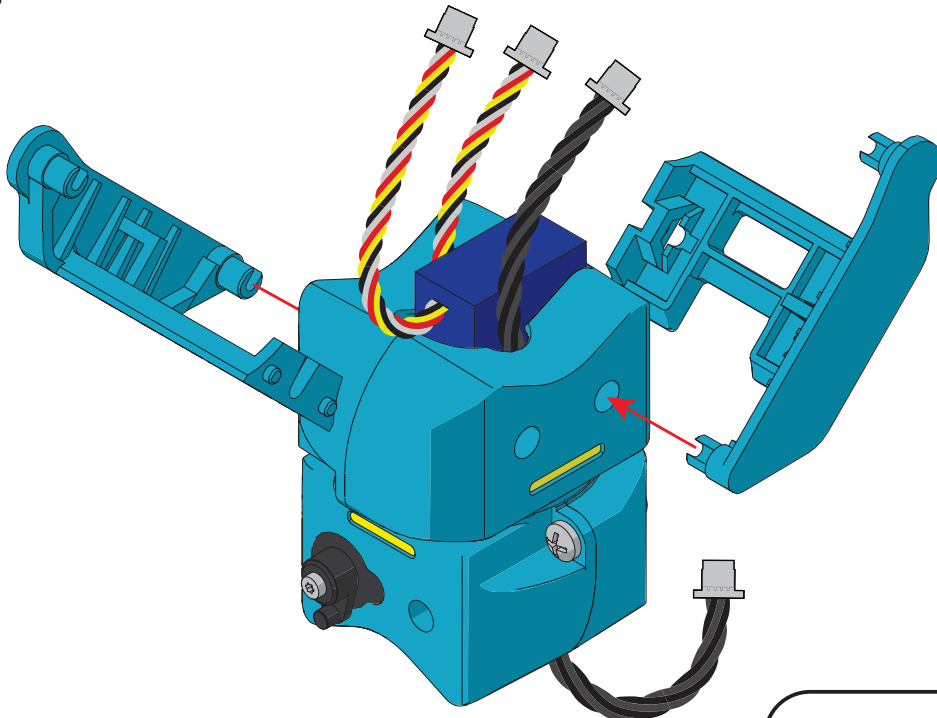
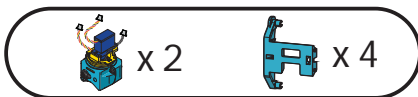

Build 2

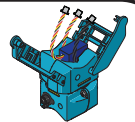

8

Both Legs

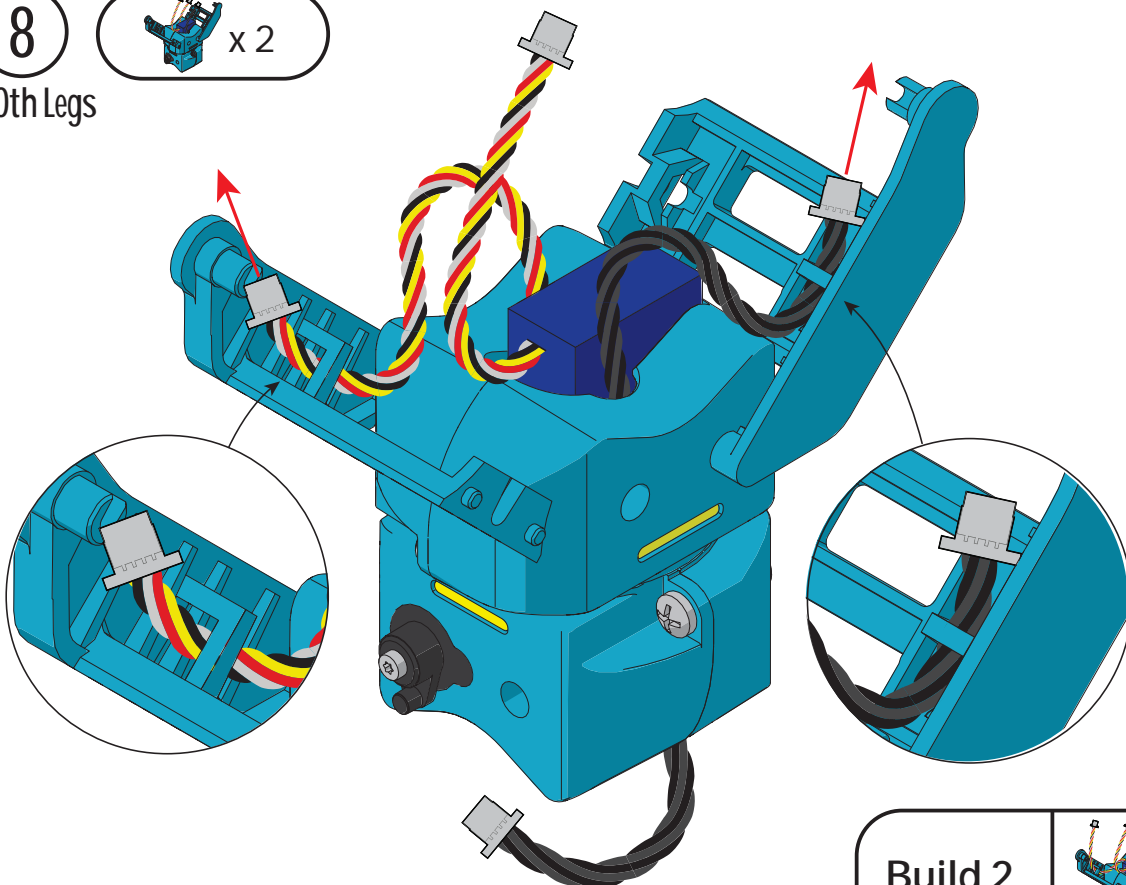
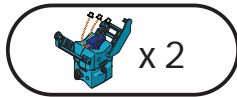

Build 2

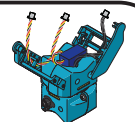



9

Both Legs

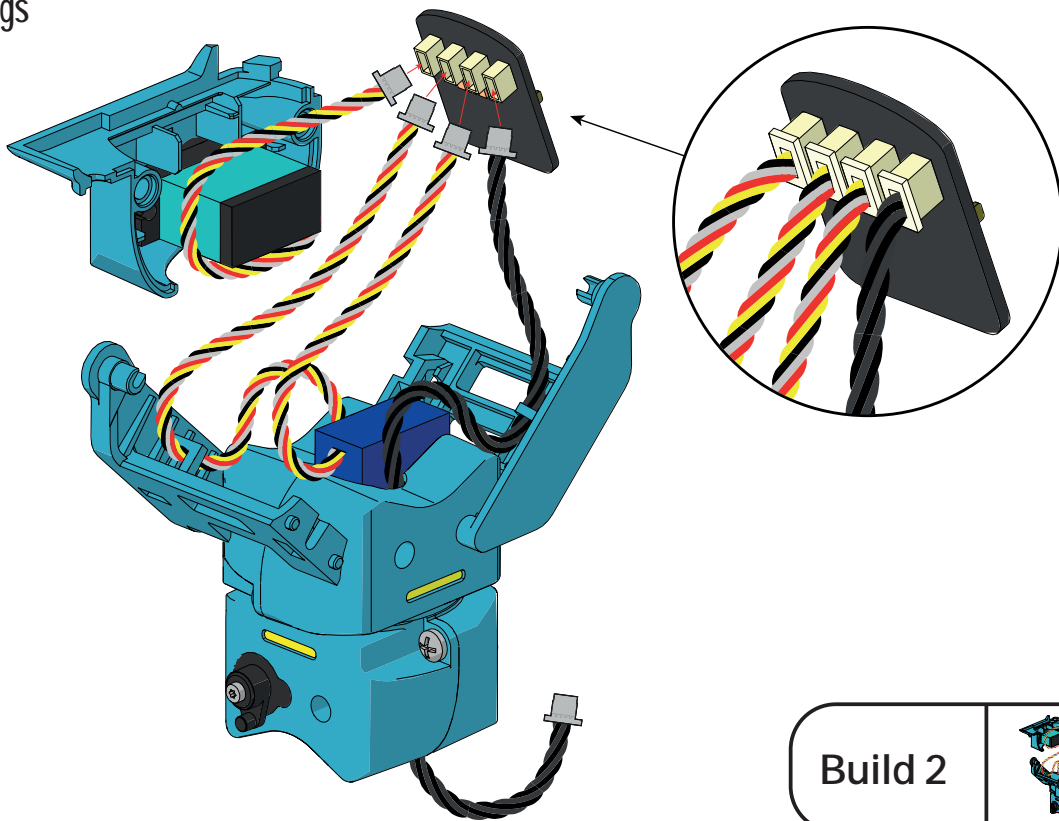
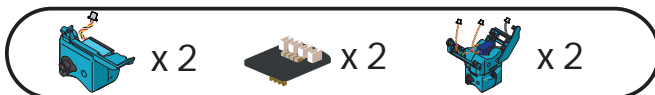

Build 2

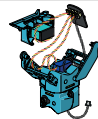

10

Both Legs

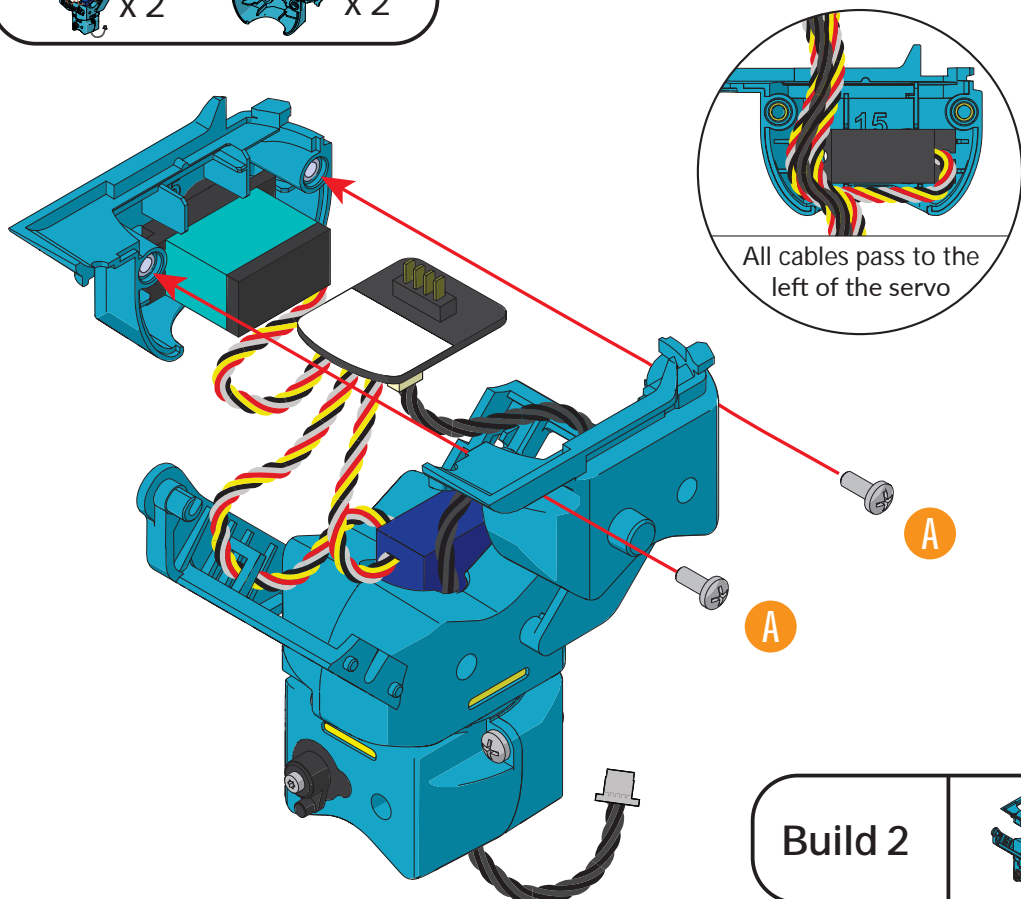

All cables pass to the left of the servo

Build 2

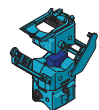

11



Both Legs

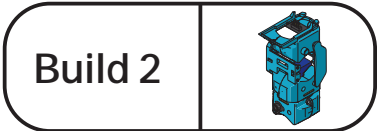
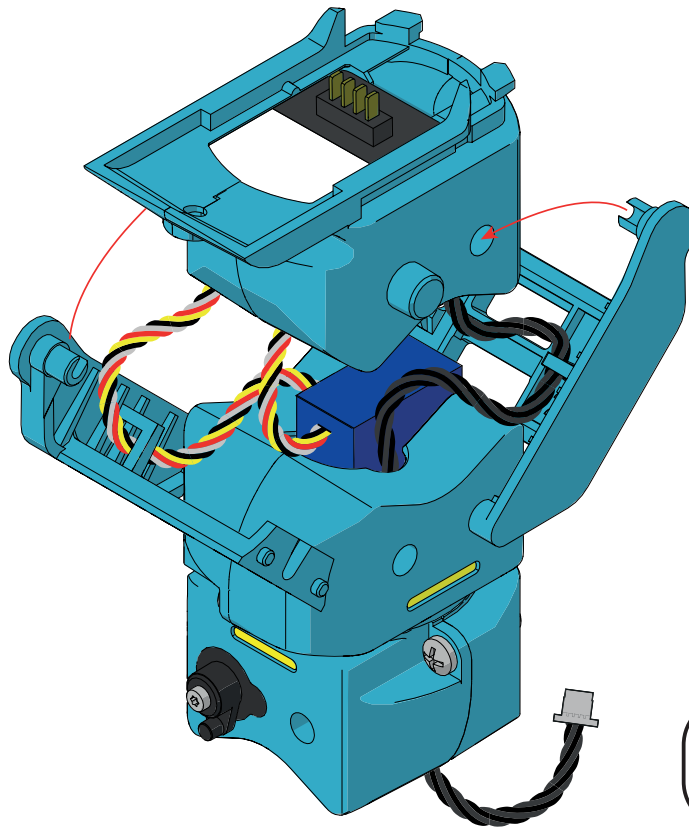

12

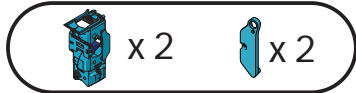

Both Legs

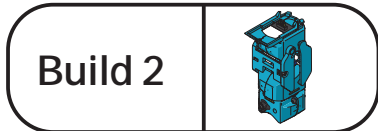
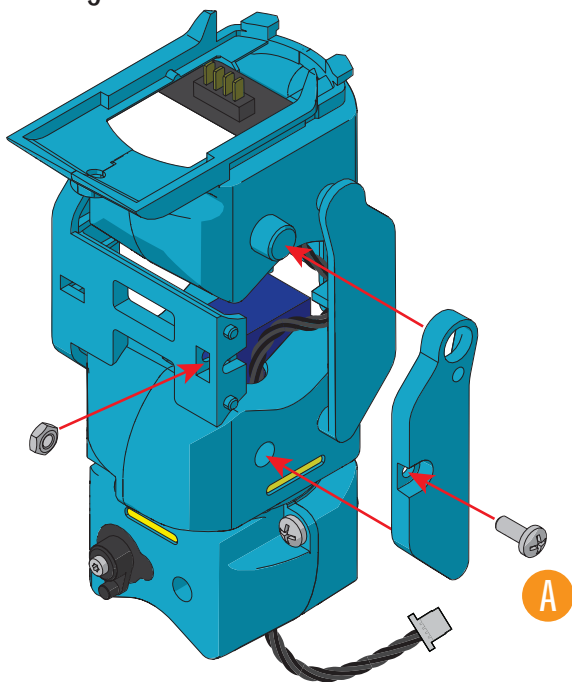

13

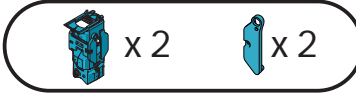

Both Legs

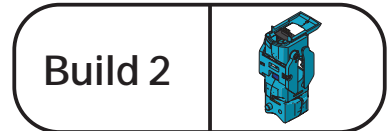
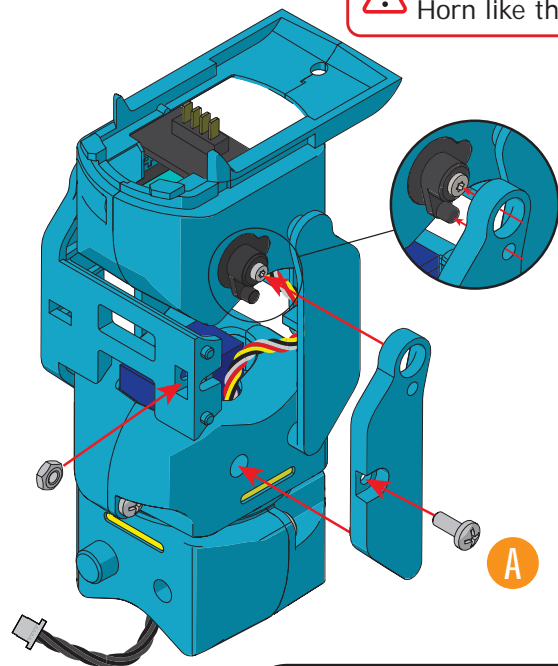

⚠ Engage Servo Horn like this

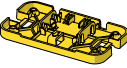
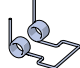

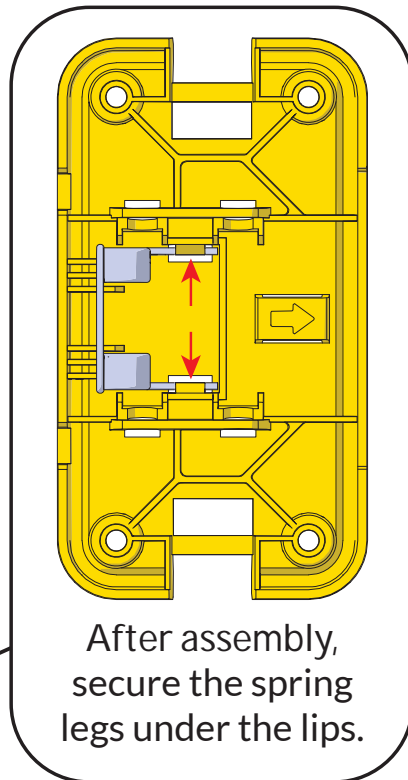
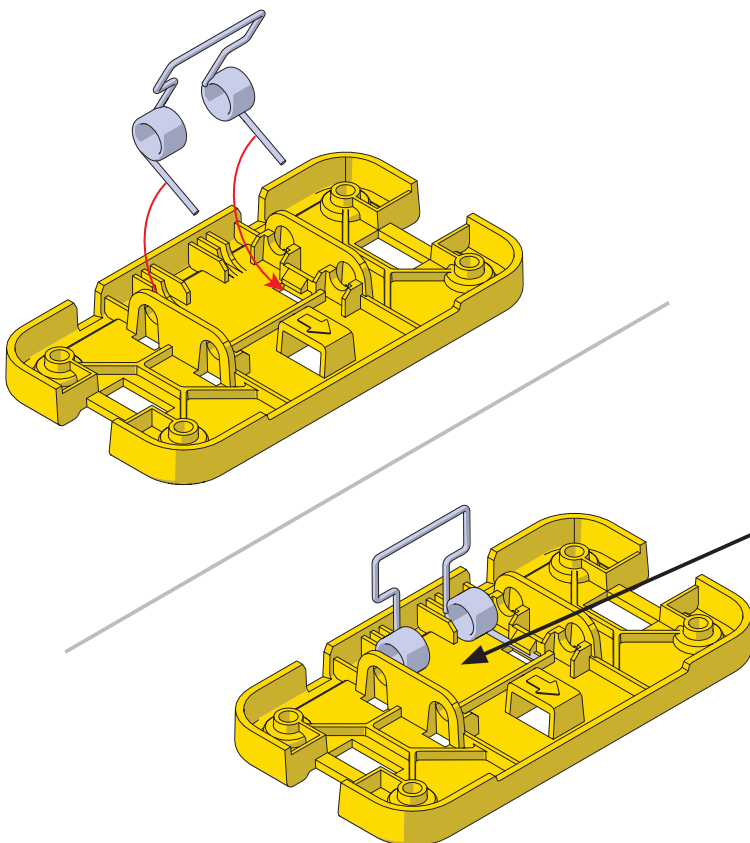
14  x 2  x 2

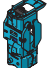

Build 2 feet 

15  x 1  x 1  x 1

Left Leg

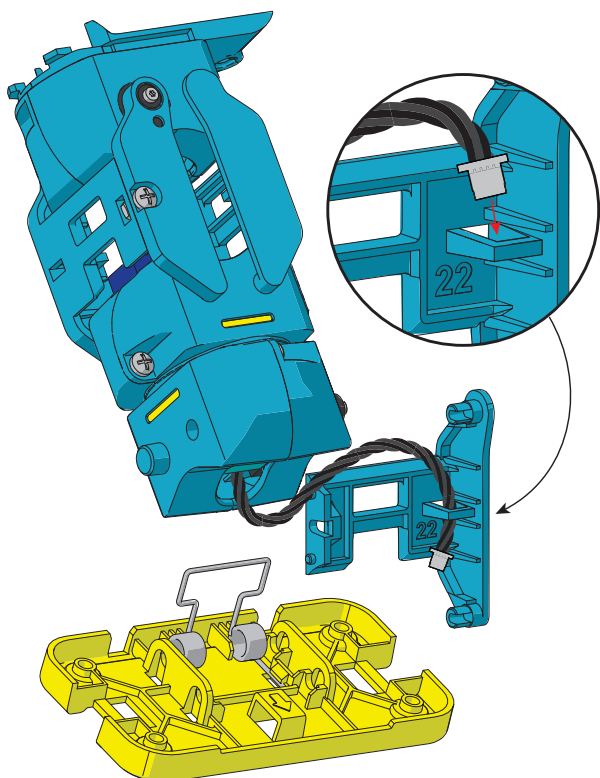

16  x 1

Left Leg

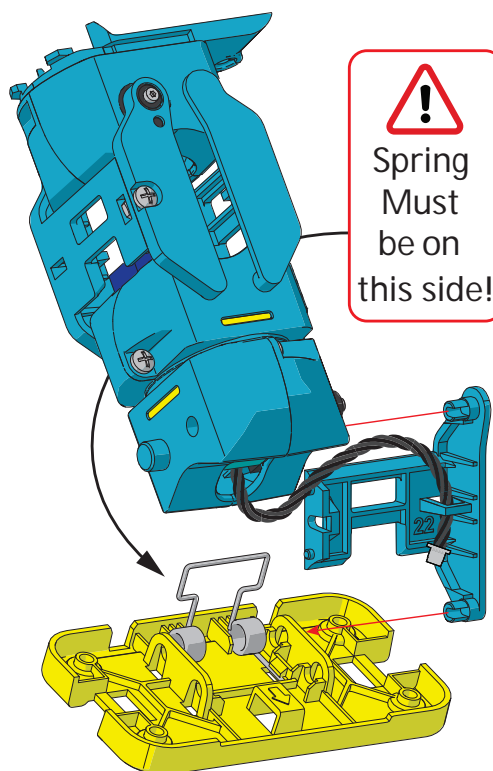

  
Spring  
Must  
be on  
this side!

17

Left Leg

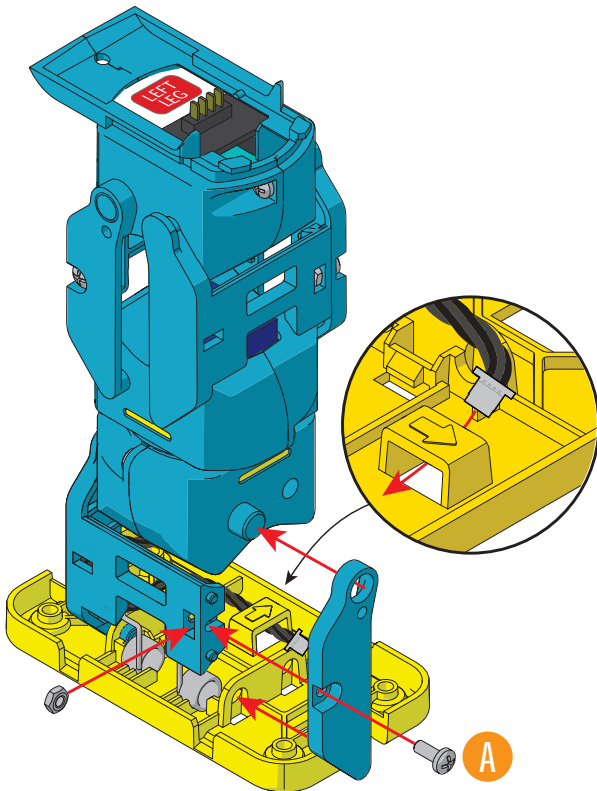

18

Left Leg

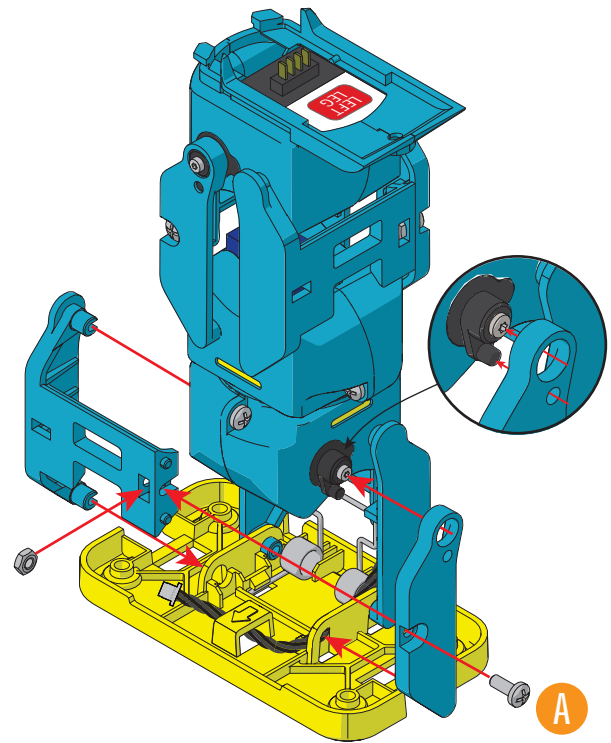

19

Left Leg

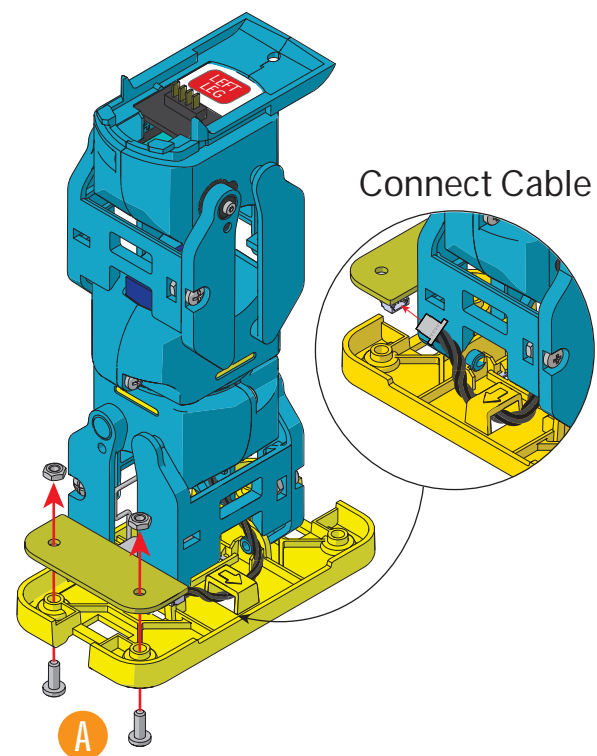

20

right Leg

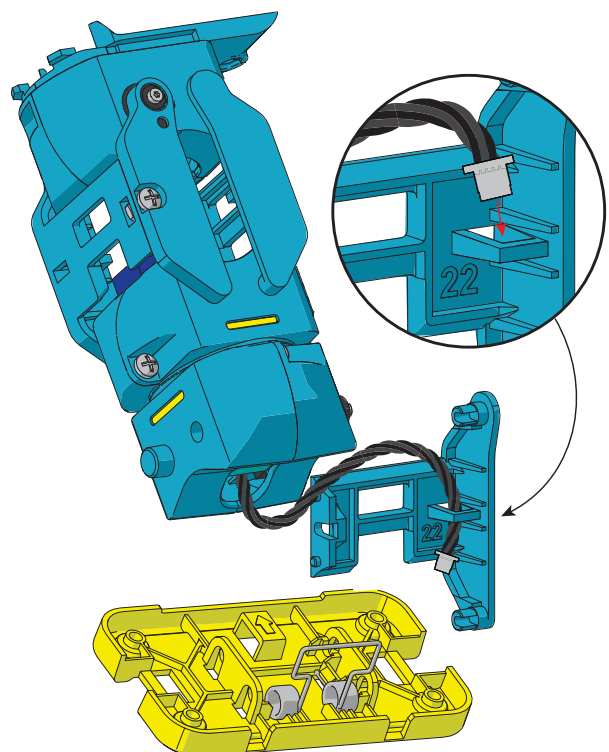

21

right Leg

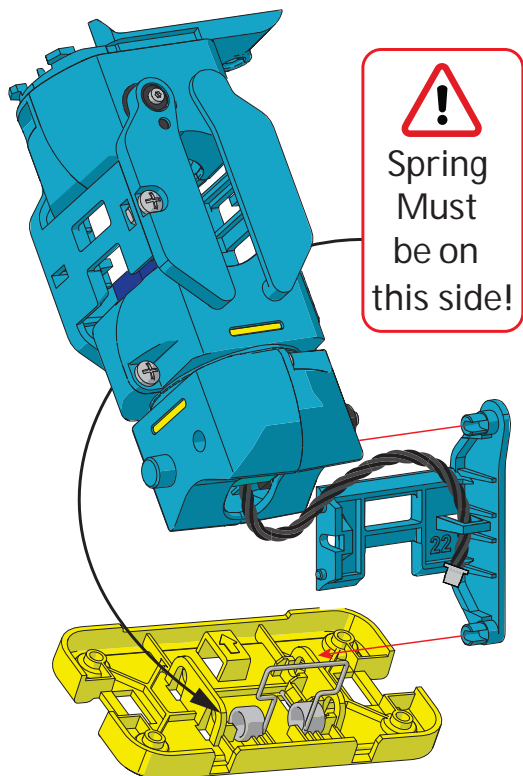

22

right Leg

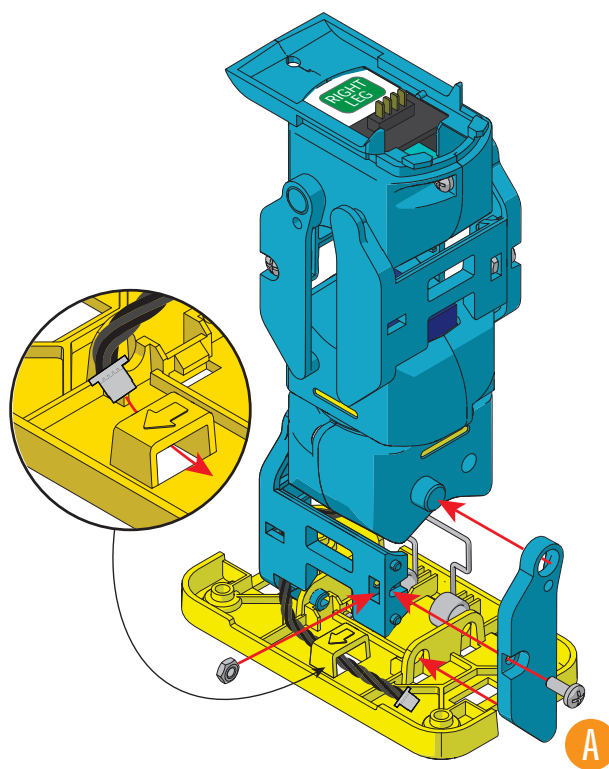

23

right Leg

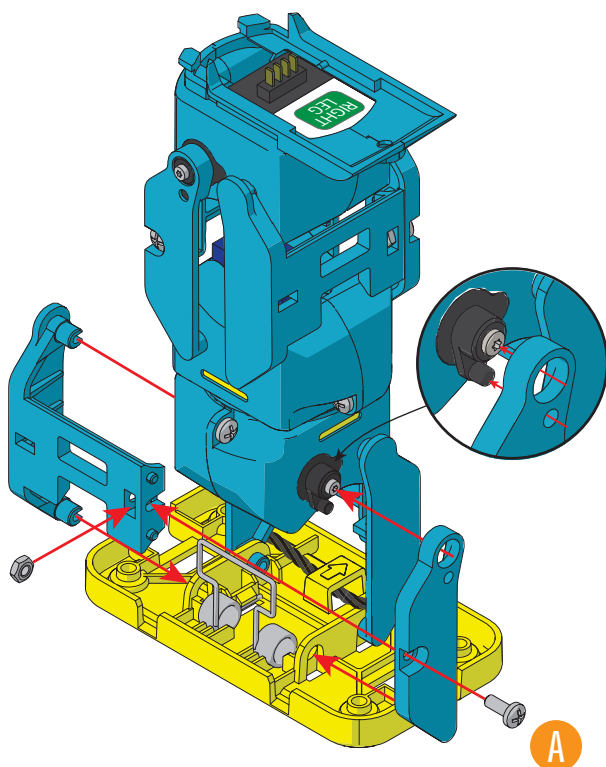

24

right Leg

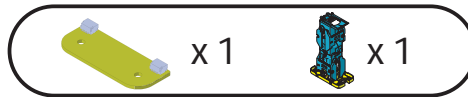

Connect Cable

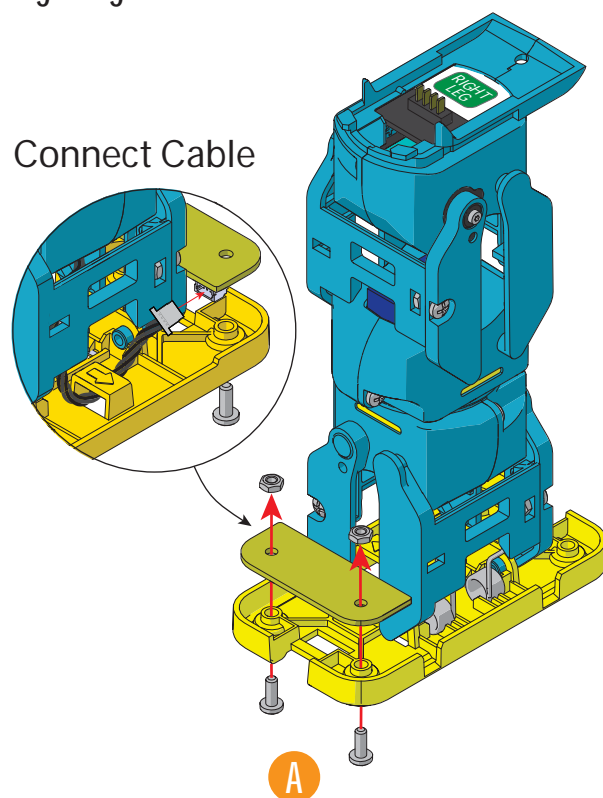



Left arm

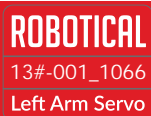

right ARM

 $\times 2$ 

x 2

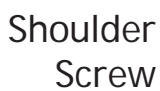

Refer to the  
**Screw Guide**  
on first page

## Build both arms



x 2

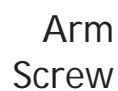

## Build both arms



28

 x 2     x 2

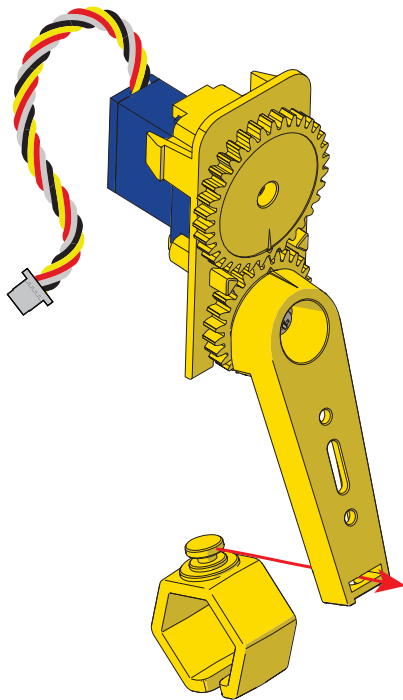

Build both arms  

29

 x 1     x 1

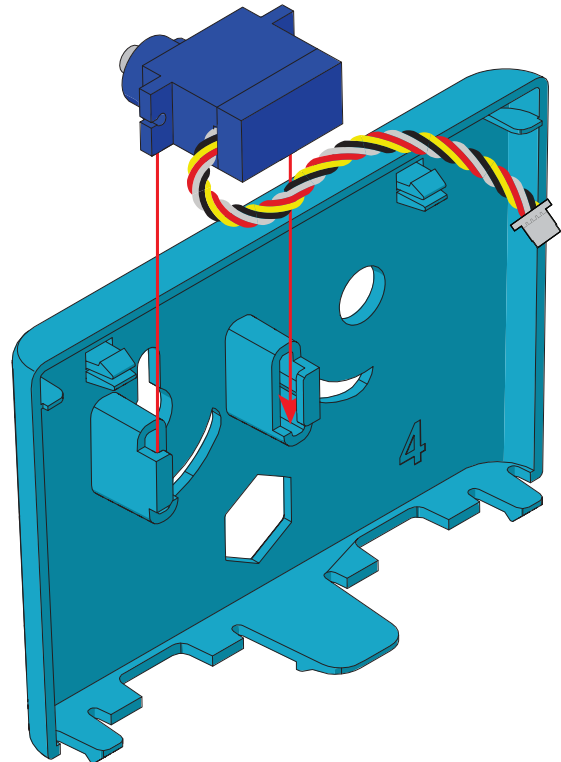

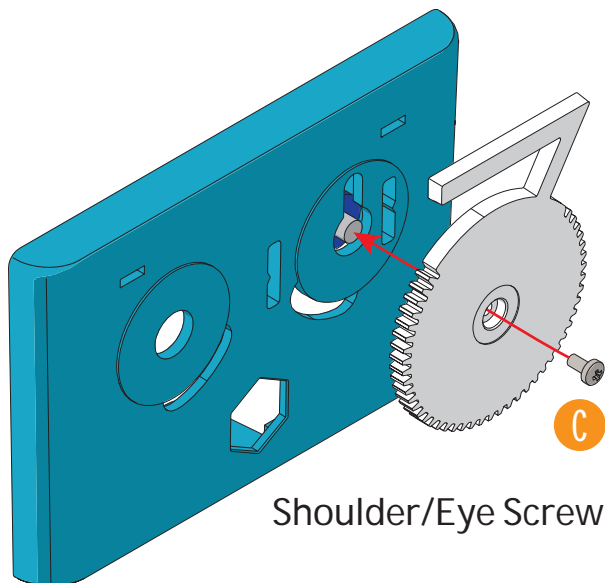

30

 x 1     x 1



31

 x 1     x 1     x 1

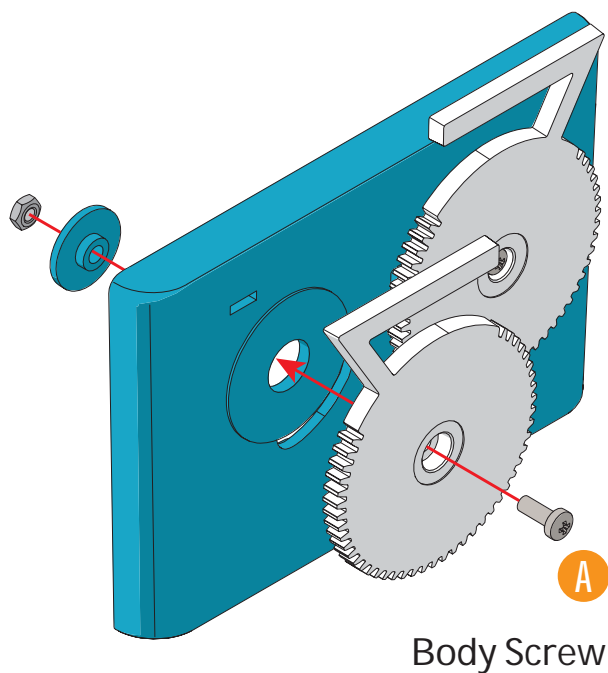

32



x 1



x 1

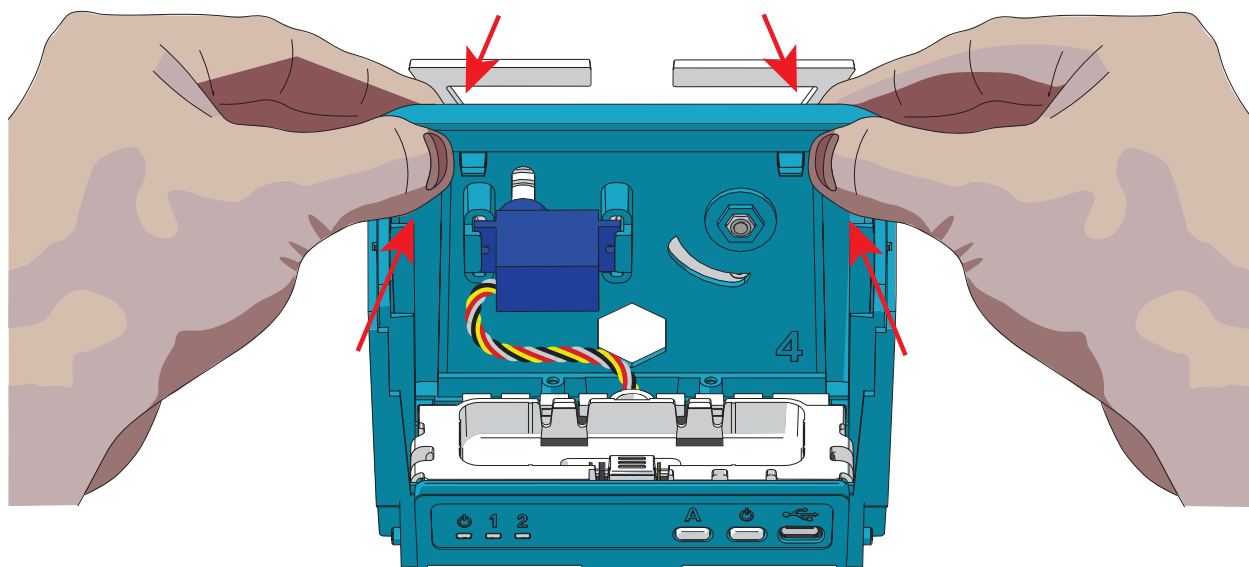
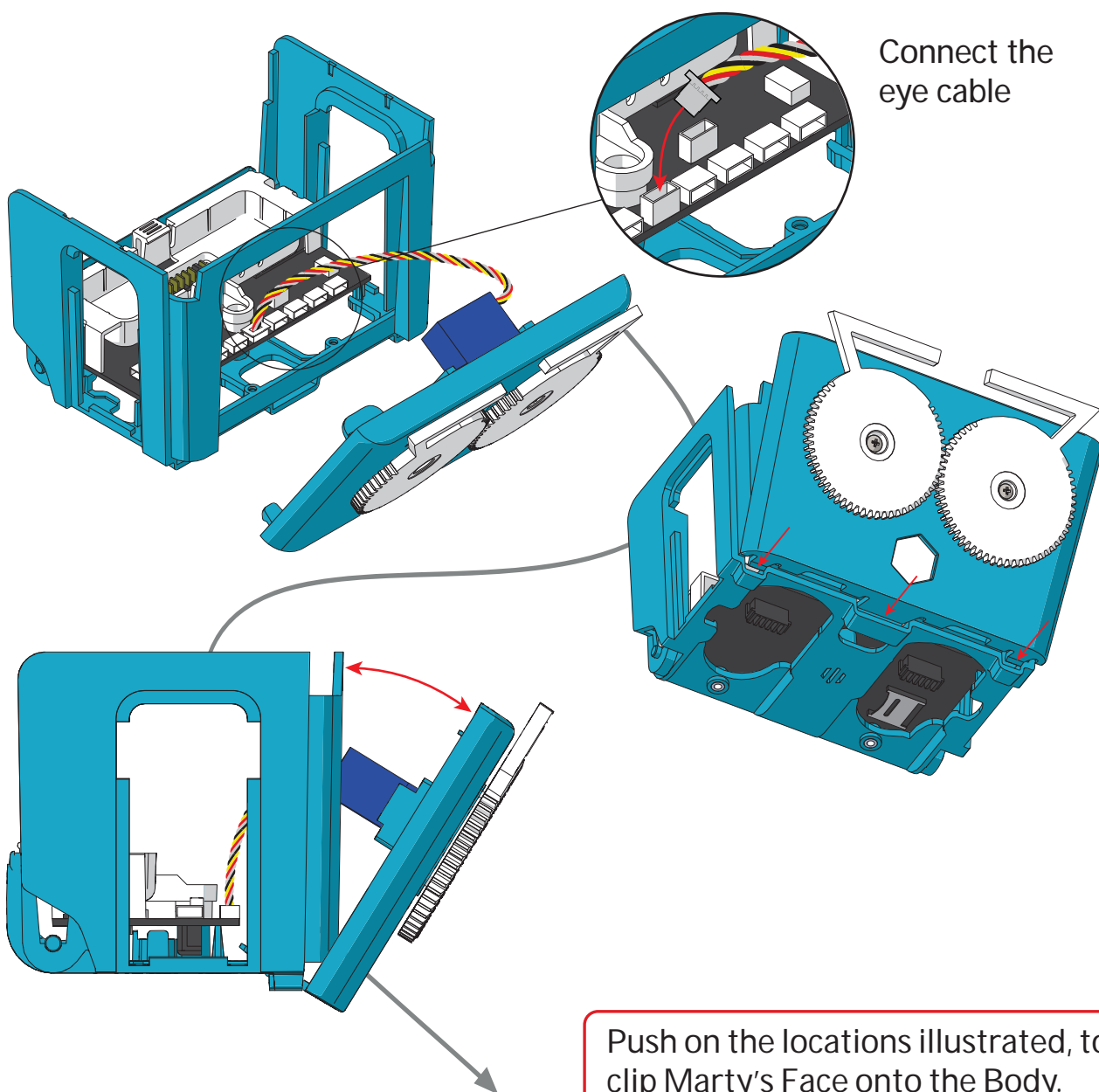



33



attach **right** leg to the body

**RIGHT  
LEG**



Attached the leg as illustrated below. Pay attention to the position of the cable to highlight orientation.

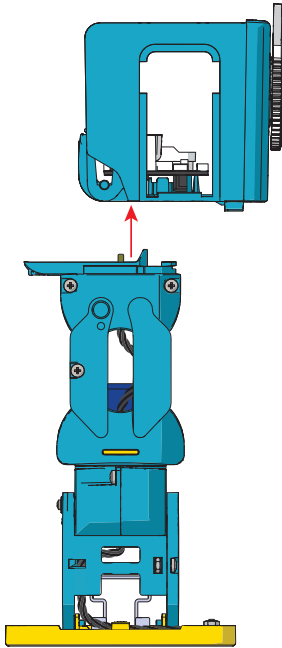

Step 1

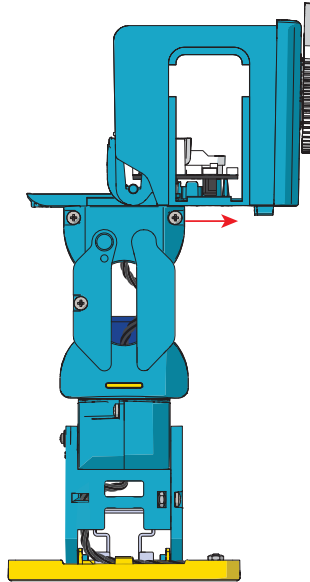

Step 2

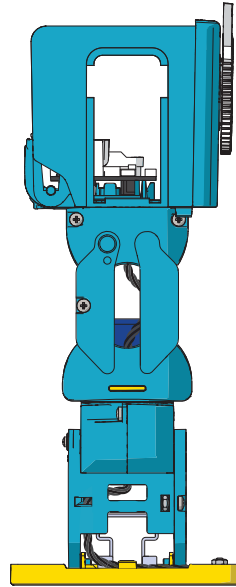

Step 3

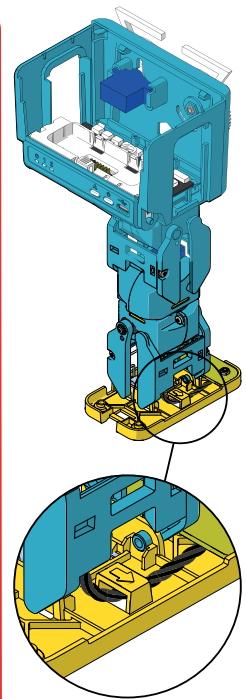

34



Attach **left** leg to the body

**LEFT  
LEG**



Attached the leg as illustrated below. Pay attention to the position of the cable to highlight orientation.

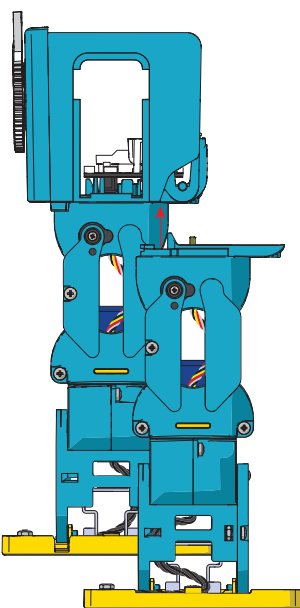

Step 1

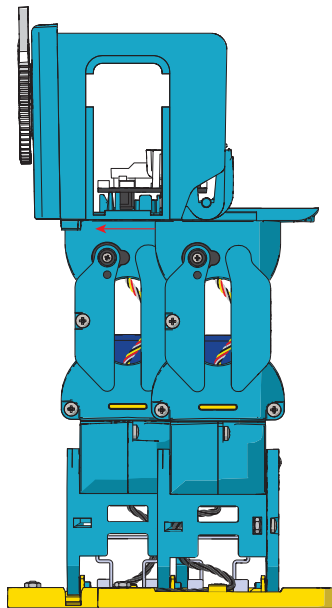

Step 2

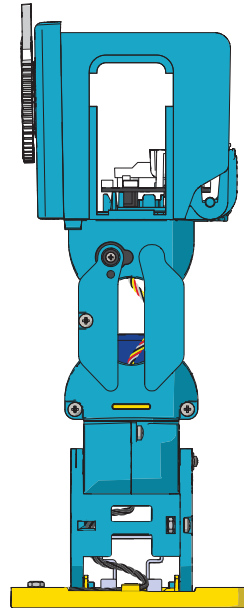

Step 3

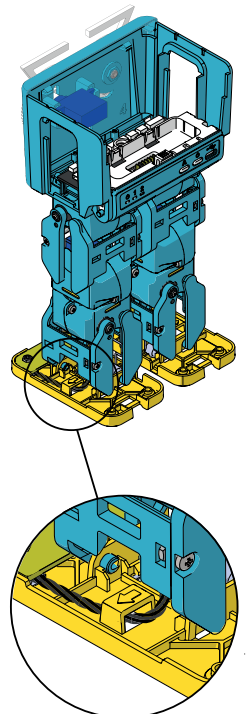

35



x 1

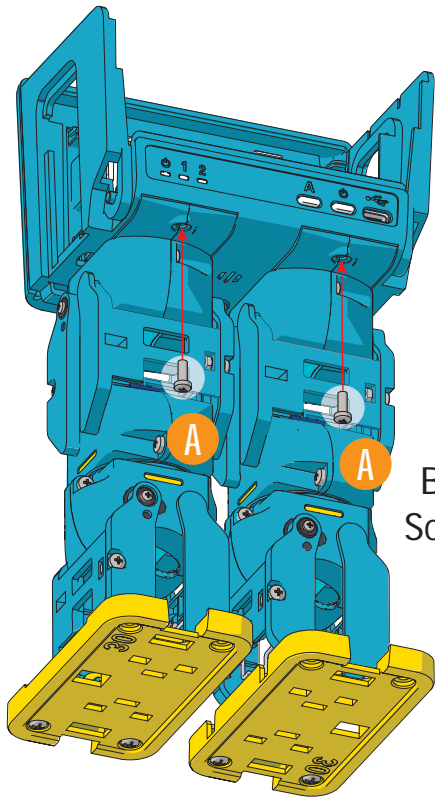

Body  
Screw

36



x 1

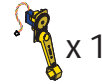

x 1



x 1

Connect the arm cables

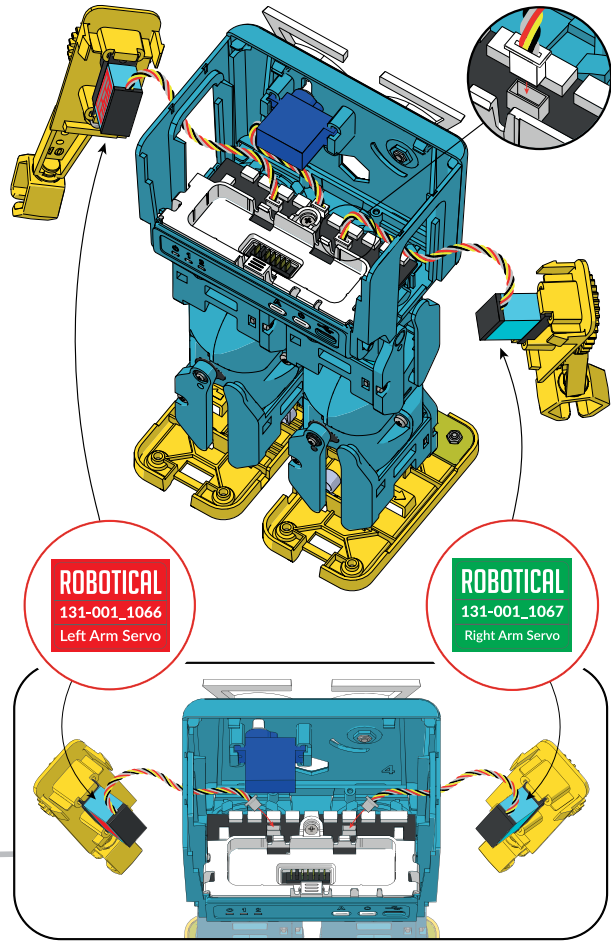

Clip the arms into the body

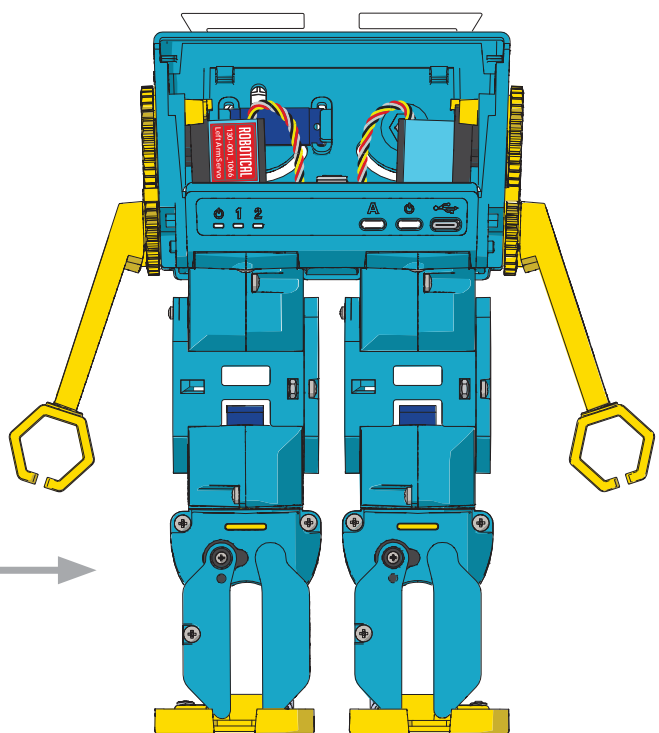
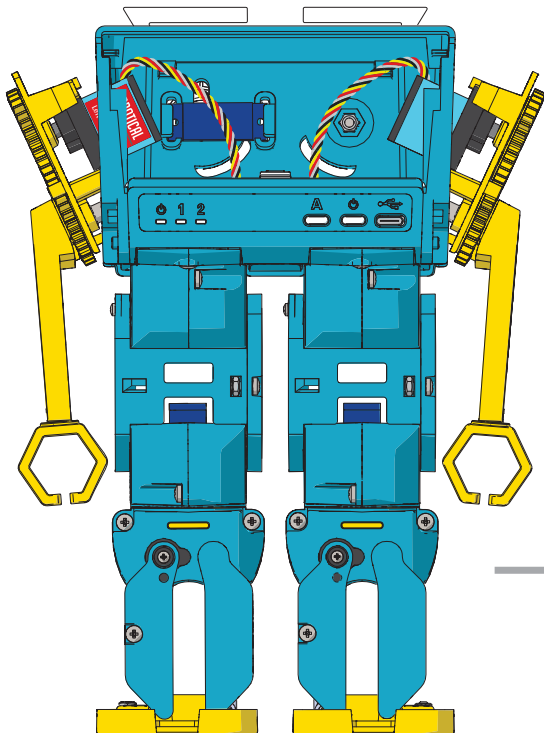

37



x 1



x 1

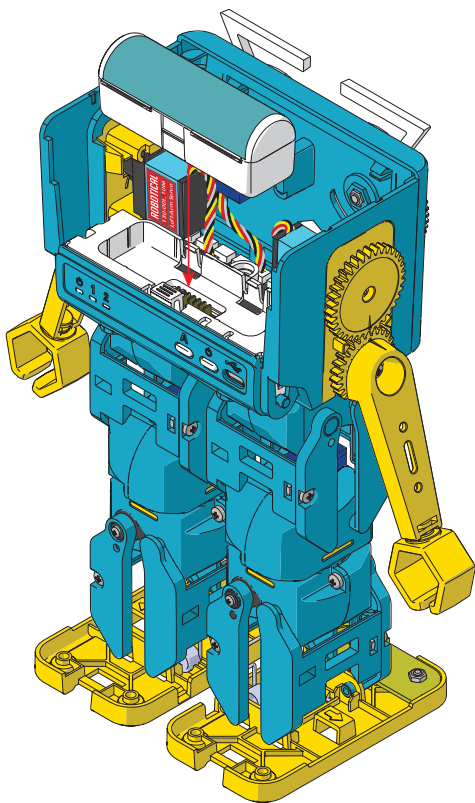

38



x 1

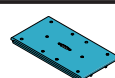

x 1

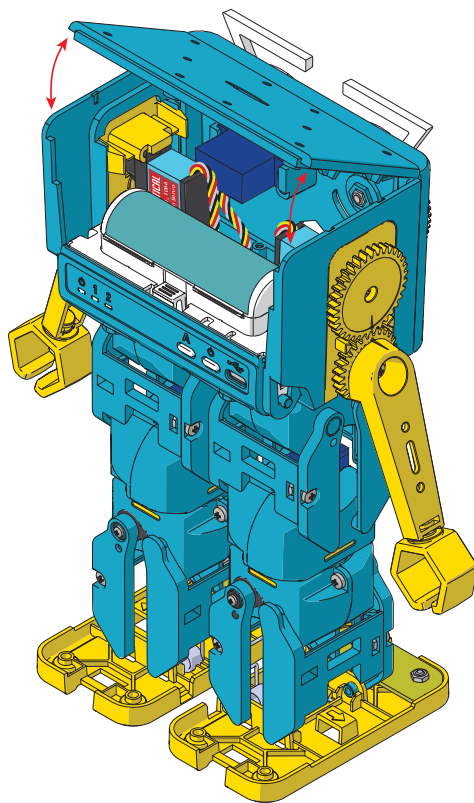

39



x 1



x 1

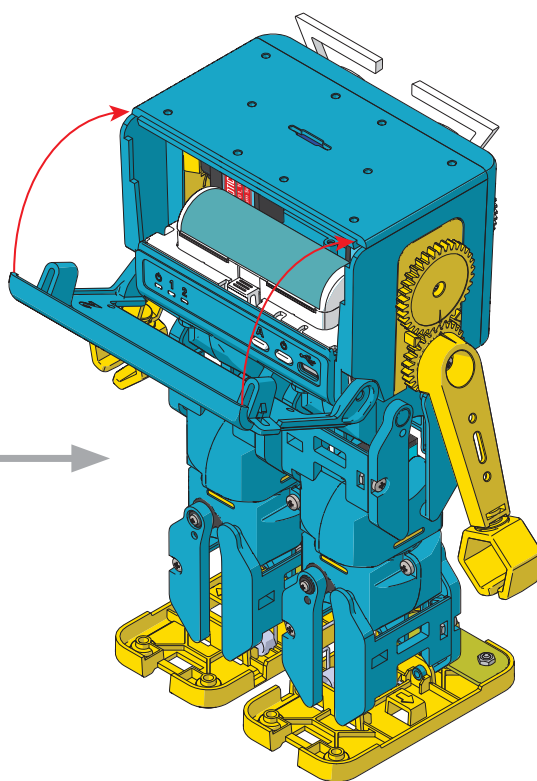
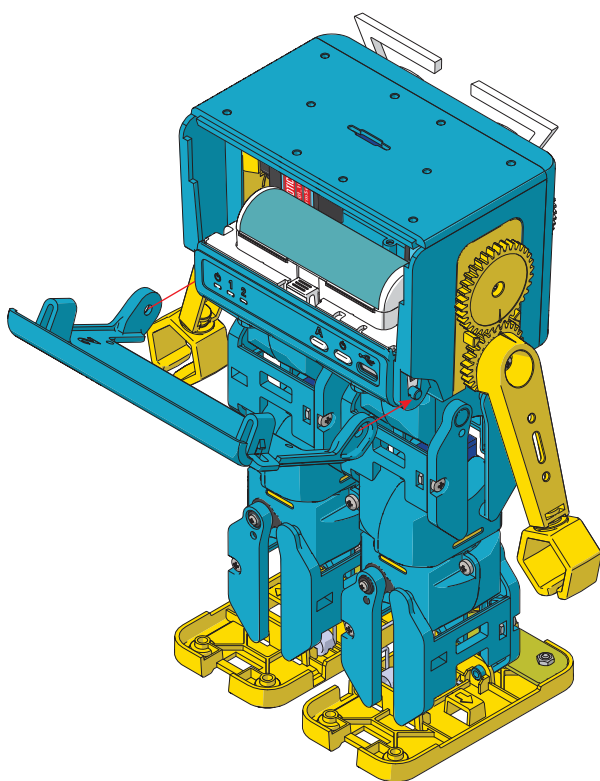

40



x 1 Sticker Sheet

Personalise your Marty!

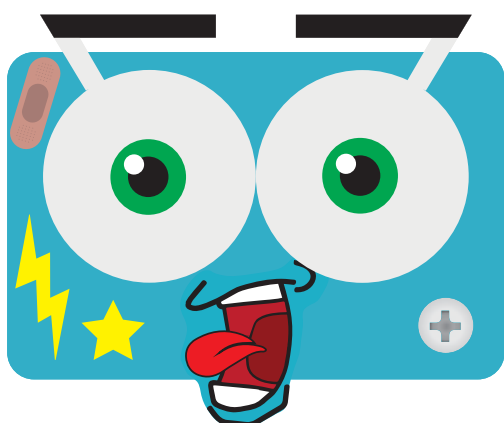
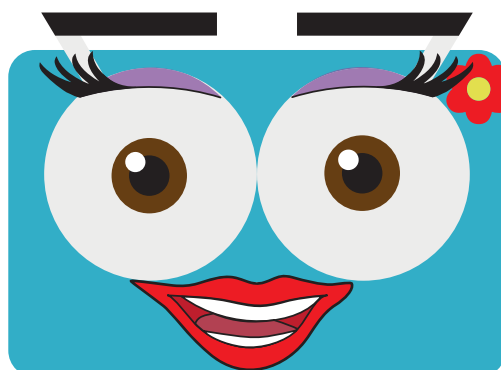
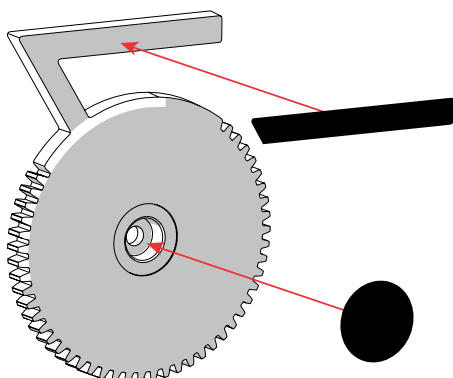

## Next Steps

You have now finished building your Marty

To set-up your Marty and start coding,  
download the Marty the Robot App  
and follow the on screen instructions





