





# WHERE TO START!

**Robot Kit** - Step 1

**Partly-assembled Kit** - Step 25

**Assembled Robot** - Ready to Code

## TOP TIPS

- Get help from an adult if you're under 14.
- Pay attention to the part orientation.
- Try not to trap or squish the cables.
- Check you have all the parts.
- Be gentle with the motors.
- Do the steps in order.
- Have fun!

**Top Tip:** Use the Marty App or our online support for extra help & tips.

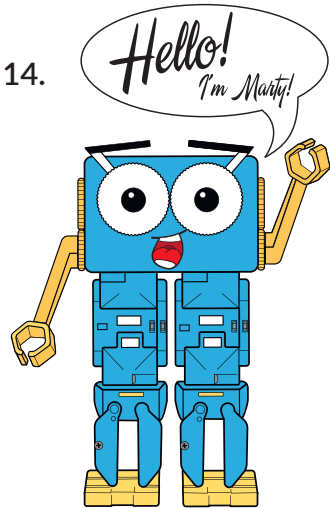

## SCREW GUIDE

When you see an icon like this **A** use the **SCREW GUIDE** below to select the correct screw.

**A**

Size Guide



Body Screw

**C**

Size Guide



Shoulder/ Eye Screw

**B**

Size Guide

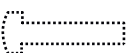

Arm Screw

1-L

LEFT LEG



x 1



x 1

ROBOTICAL  
13#-001\_1060  
Left Hip Servo

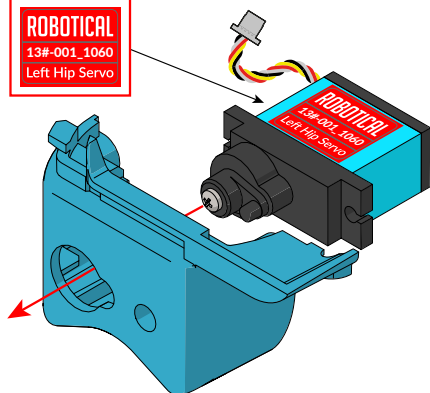

Twist 90°

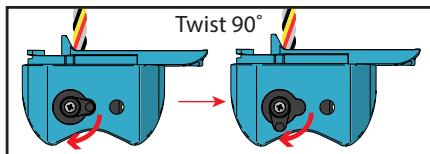

1-R

RIGHT LEG



x 1



x 1

ROBOTICAL  
13#-001\_1063  
Right Hip Servo

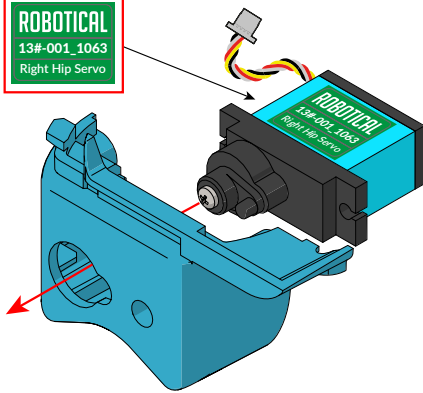

Twist 90°

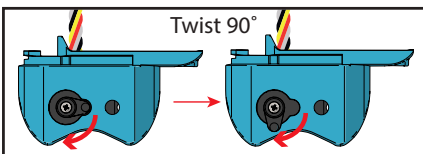

2-L

LEFT LEG



x 1



x 1

ROBOTICAL  
13#-001\_1062  
Left Knee Servo

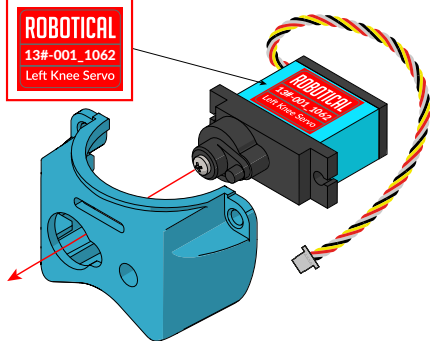

Twist 90°

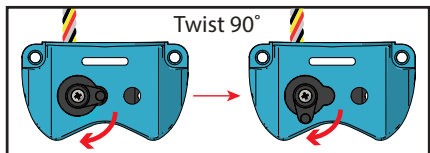

2-R

RIGHT LEG



x 1



x 1

ROBOTICAL  
13#-001\_1065  
Right Knee Servo

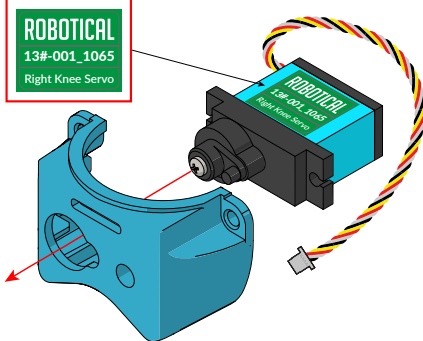

Twist 90°

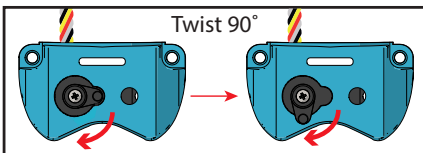

3-L

LEFT LEG



x 1



x 1



x 1



x 1

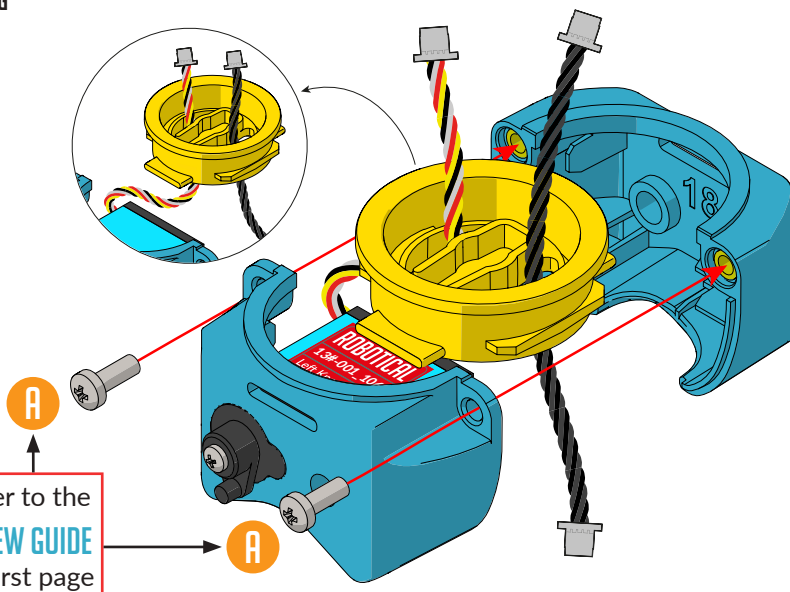

3-R

RIGHT LEG



x 1



x 1



x 1



x 1

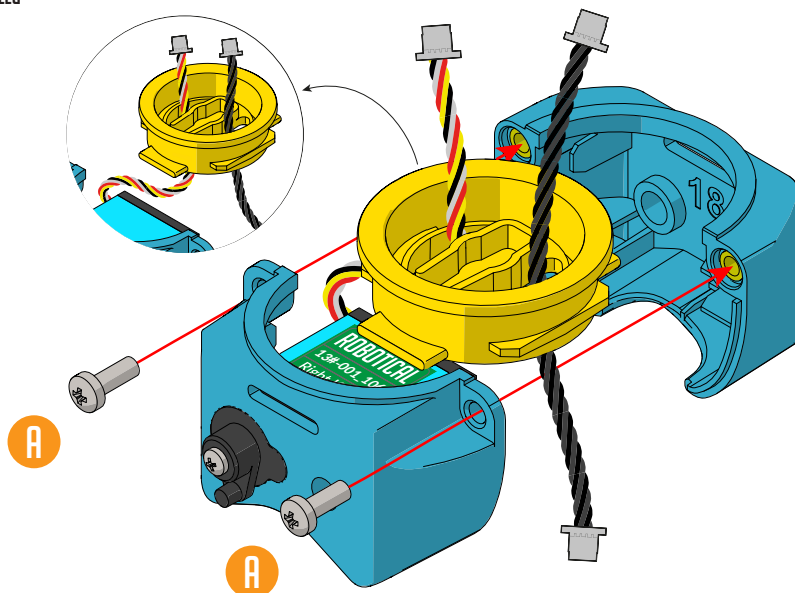

4-L

LEFT LEG



x 1



x 1

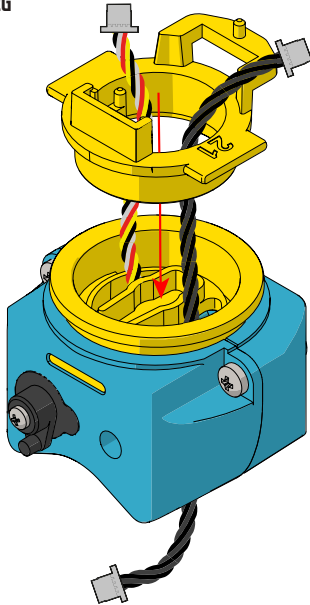

4-R

RIGHT LEG



x 1



x 1

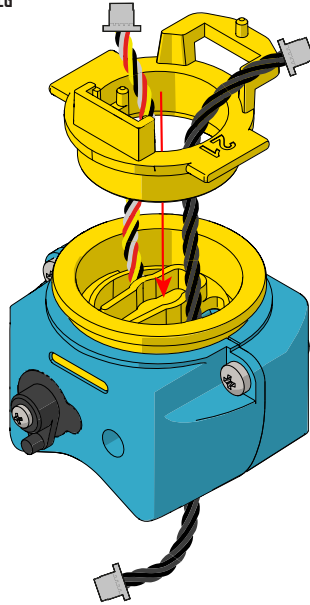

5-L

LEFT LEG



x 1



x 1

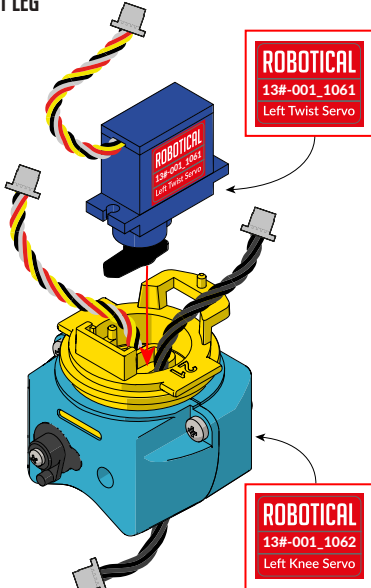

5-R

RIGHT LEG



x 1



x 1

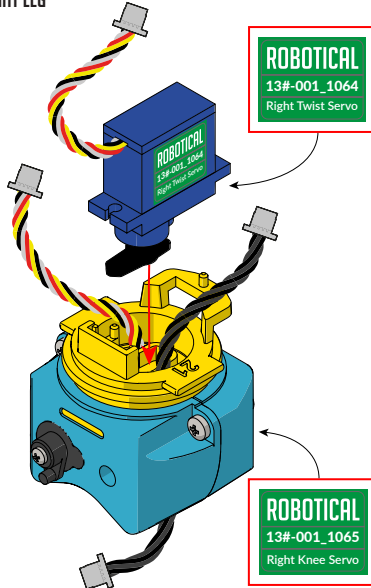

**6-L**  
LEFT LEG



x 1



x 1



x 1

LEFT LEG

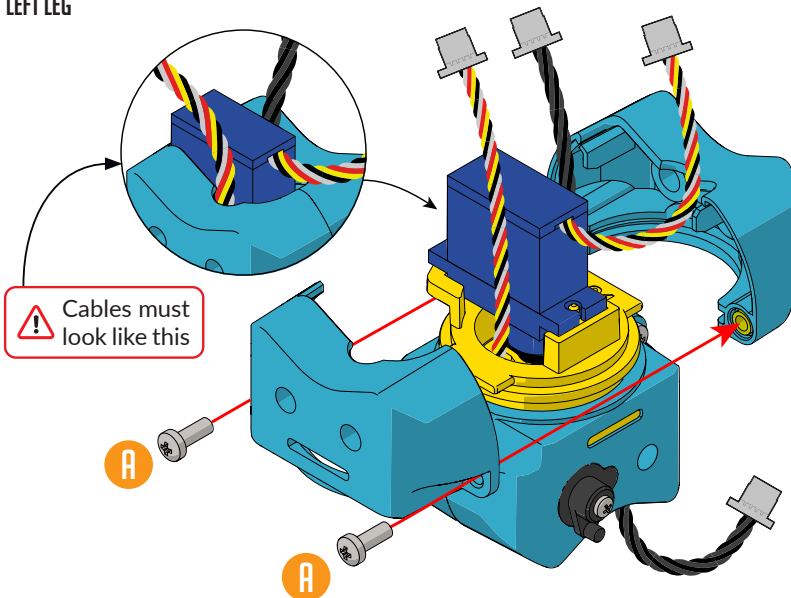

**6-R**  
RIGHT LEG



x 1



x 1



x 1

RIGHT LEG

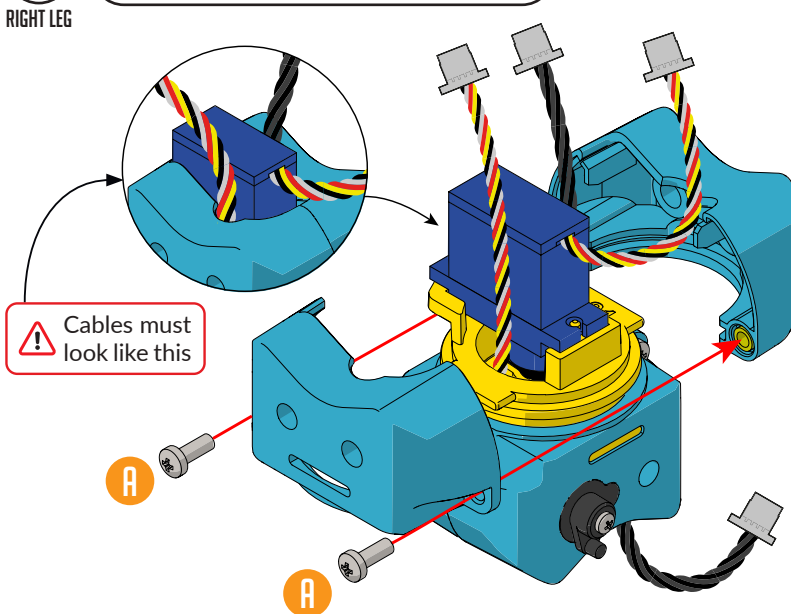

7

BOTH LEGS

 x 2     x 4

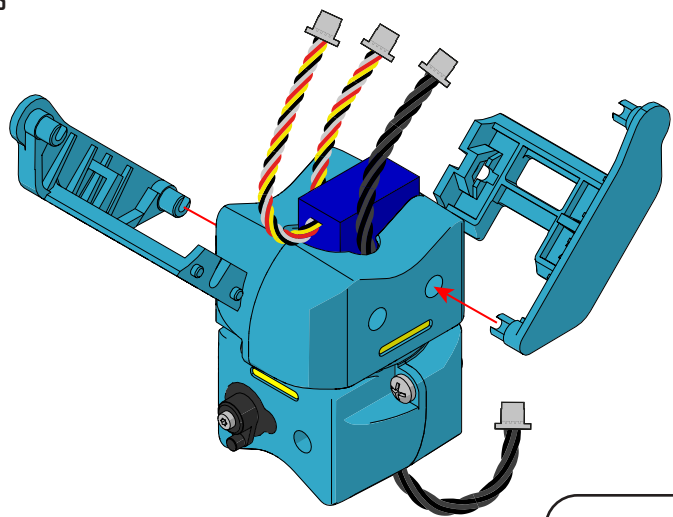

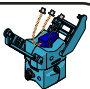
Build 2 

8

BOTH LEGS

 x 2

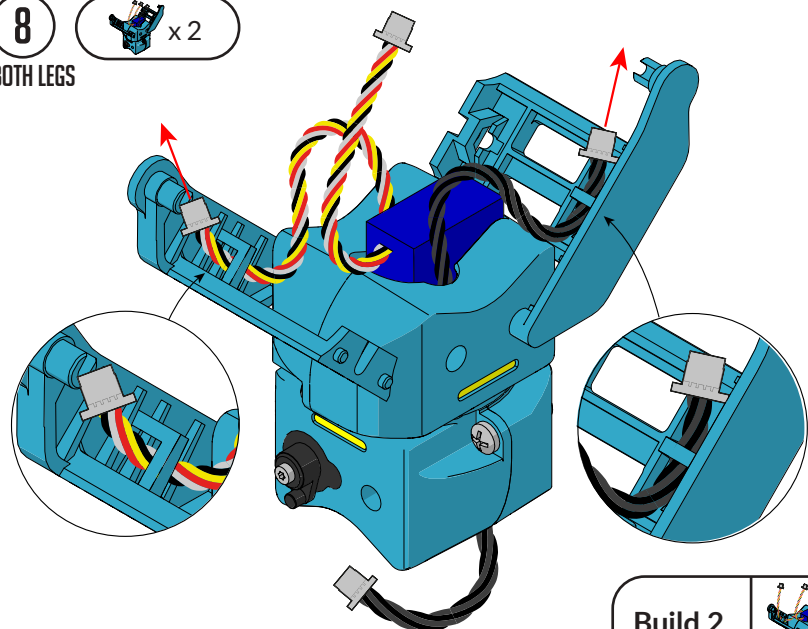

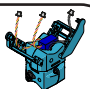
Build 2 



9

BOTH LEGS

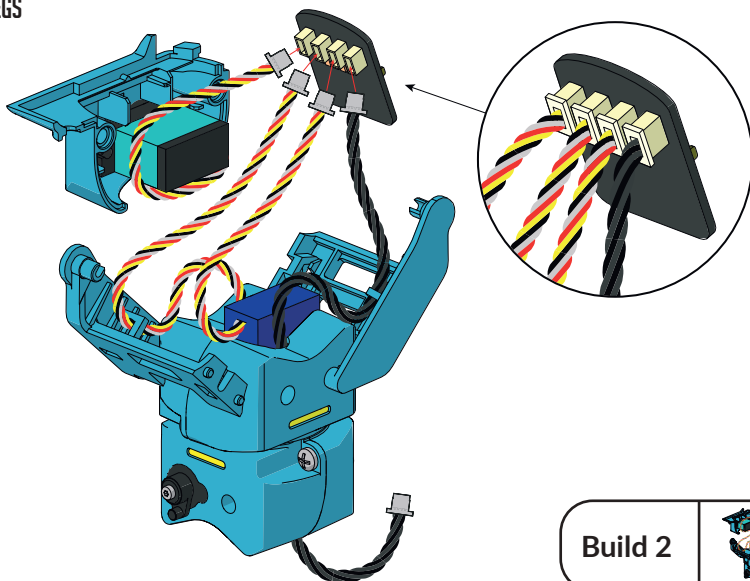

Build 2



10

BOTH LEGS

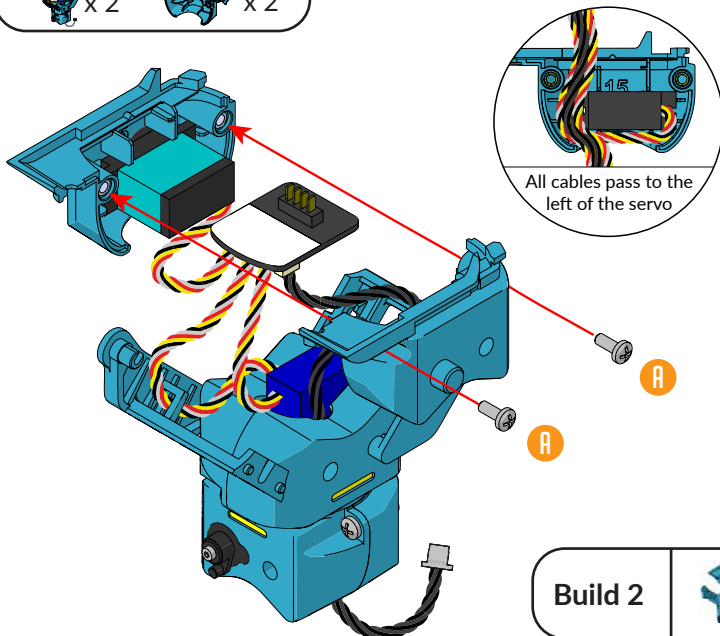

Build 2



11



x 2

BOTH LEGS

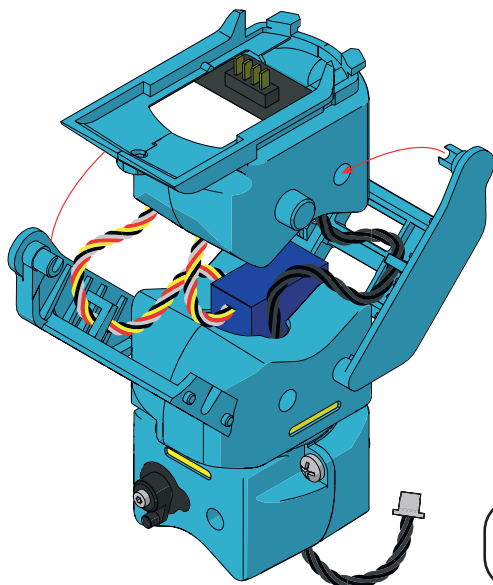

Build 2



12



x 2



x 2

BOTH LEGS

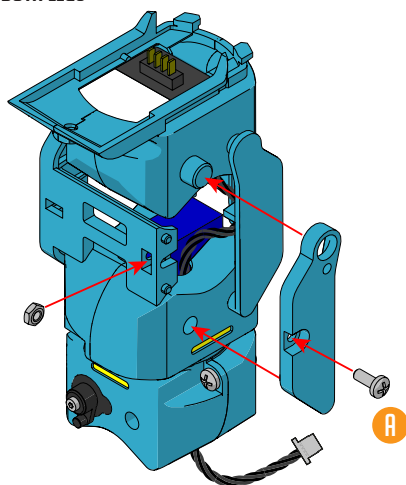

Build 2



13



x 2



x 2

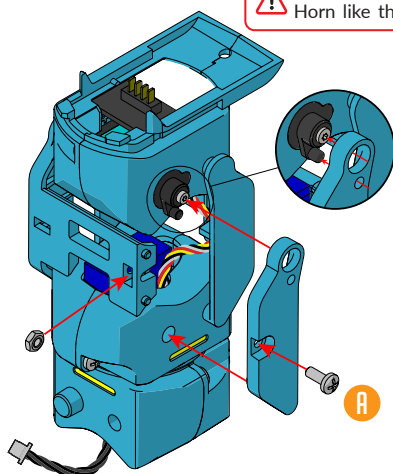

BOTH LEGS



Build 2



14

 x 2    x 2

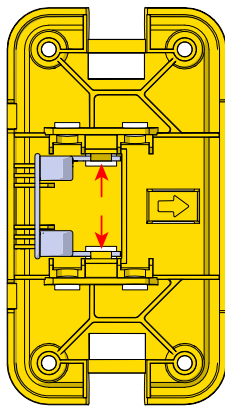
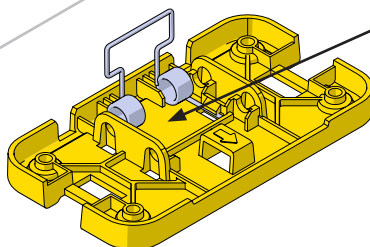
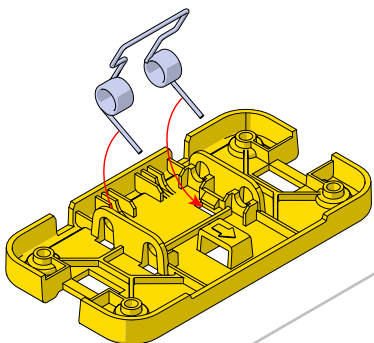

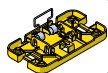

After assembly,  
secure the spring  
legs under the lips.

Build 2 feet



15

LEFT LEG

 x 1    x 1    x 1

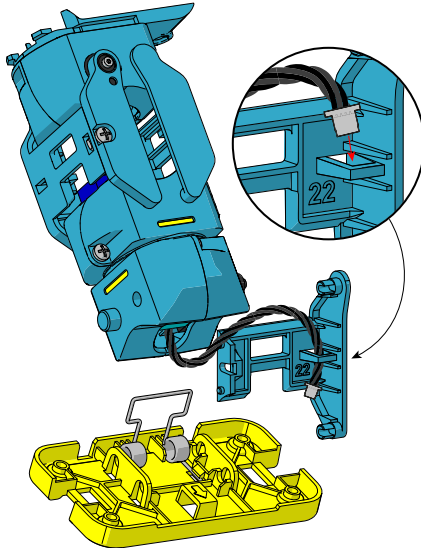

16

LEFT LEG

 x 1

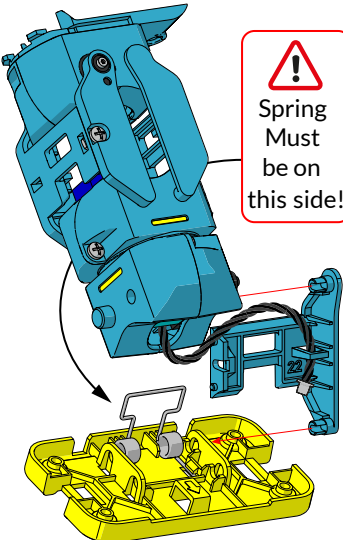

  
Spring  
Must  
be on  
this side!

17

LEFT LEG

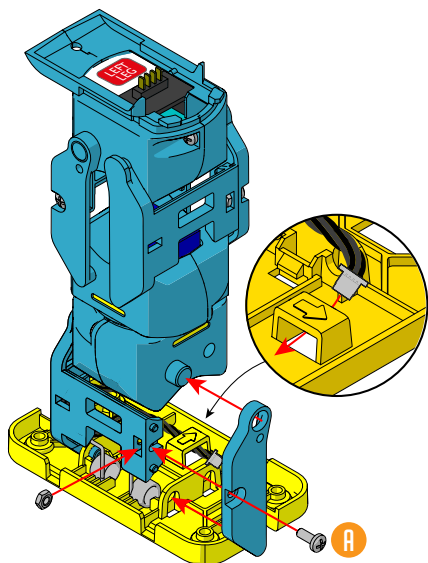

18

LEFT LEG

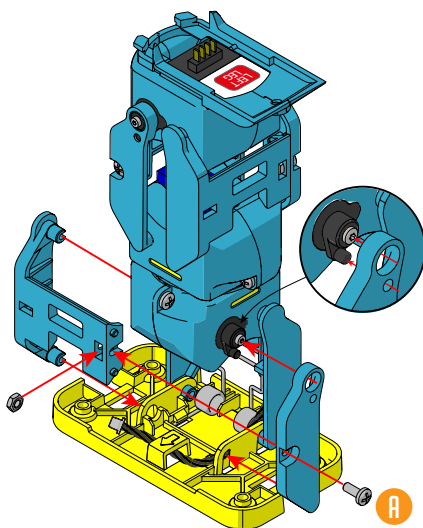
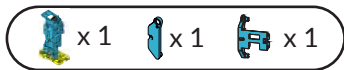

19

LEFT LEG

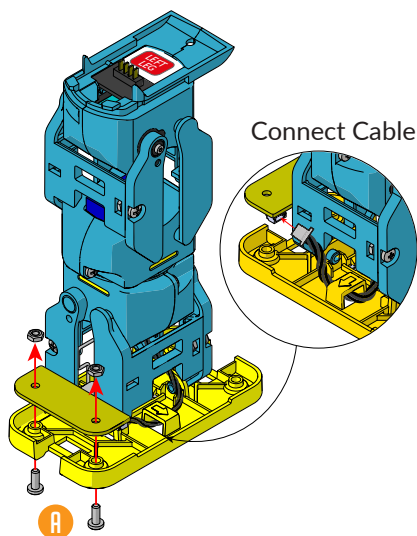
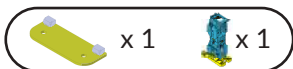

20

RIGHT LEG

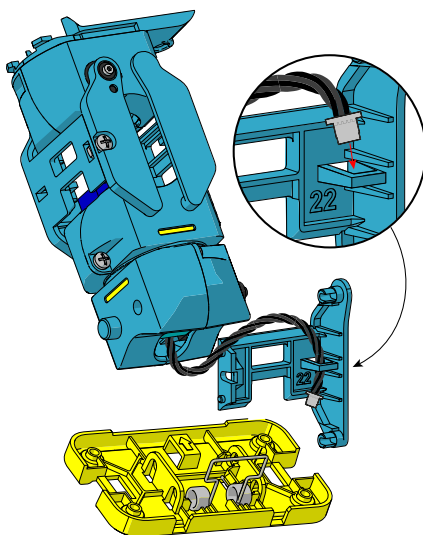
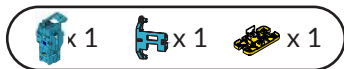

21

RIGHT LEG

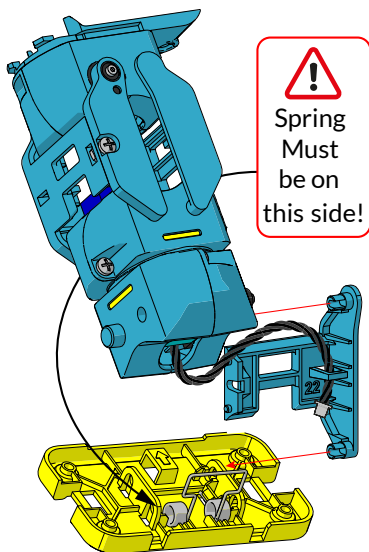

22

RIGHT LEG

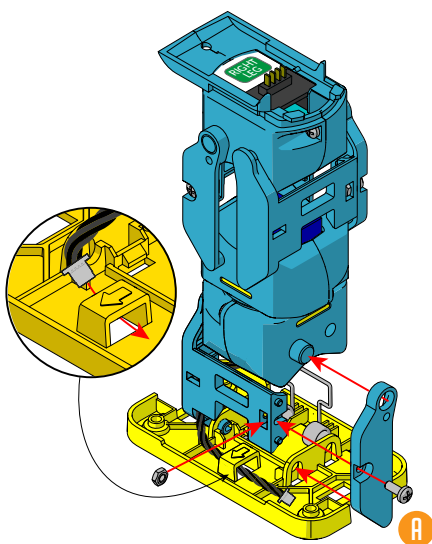
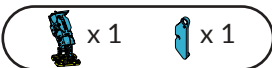

23

RIGHT LEG

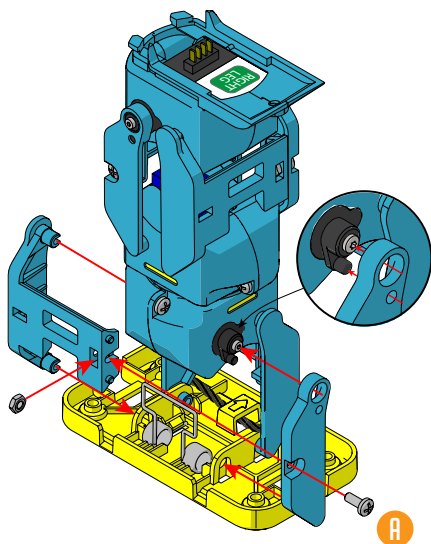
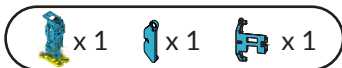

24

RIGHT LEG

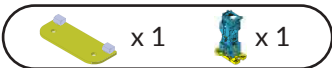

Connect Cable

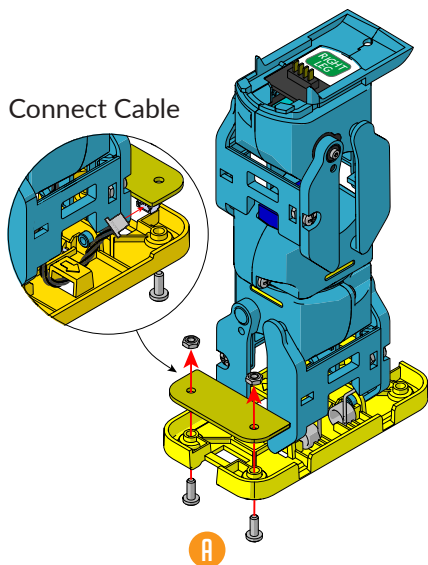

25-L

LEFT ARM



x 1



x 1

**ROBOTICAL**

13#-001\_1066

Left Arm Servo

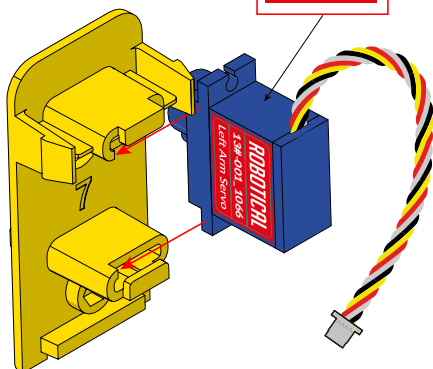

25-R

RIGHT ARM



x 1



x 1

**ROBOTICAL**

130-001\_1067

Right Arm Servo

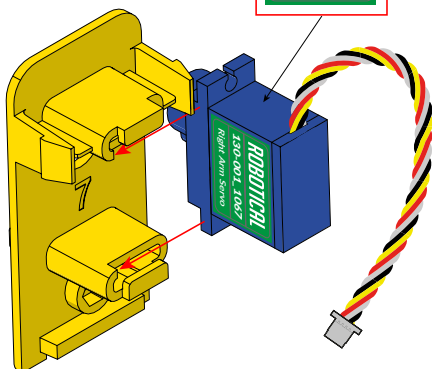

26



x 2



x 2

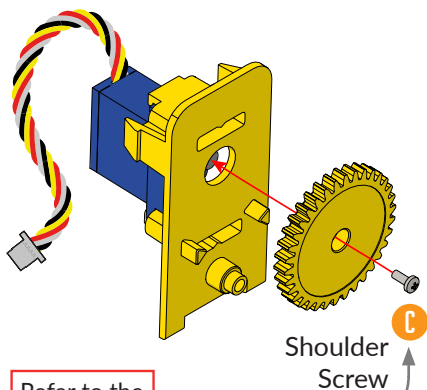

Refer to the  
**SCREW GUIDE**  
on first page

Build both arms



27



x 2



x 2



x 2

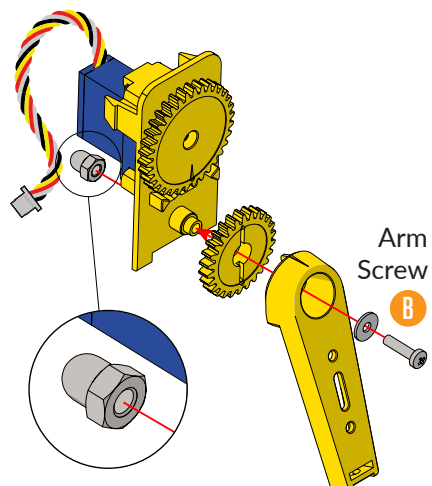

Arm  
Screw

**B**

Build both arms



28



x 2



x 2

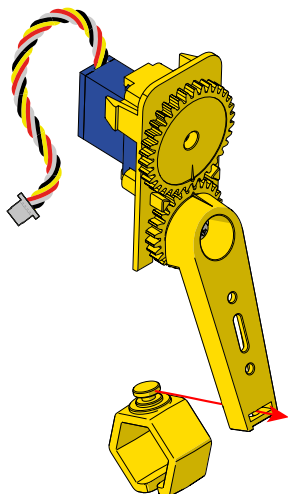

Build both arms



29



x 1



x 1

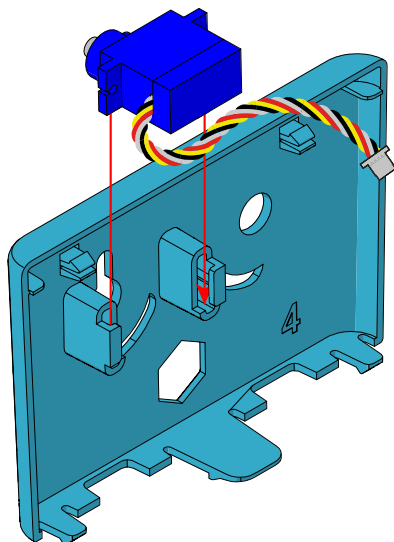

30



x 1



x 1

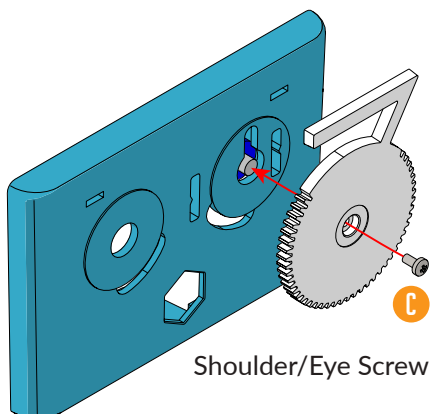

Shoulder/Eye Screw

31



x 1



x 1



x 1

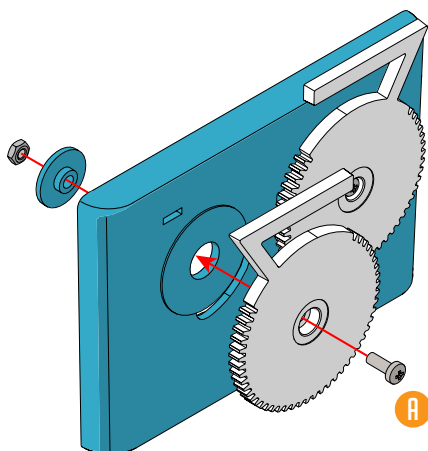

Body Screw

32



x 1



x 1

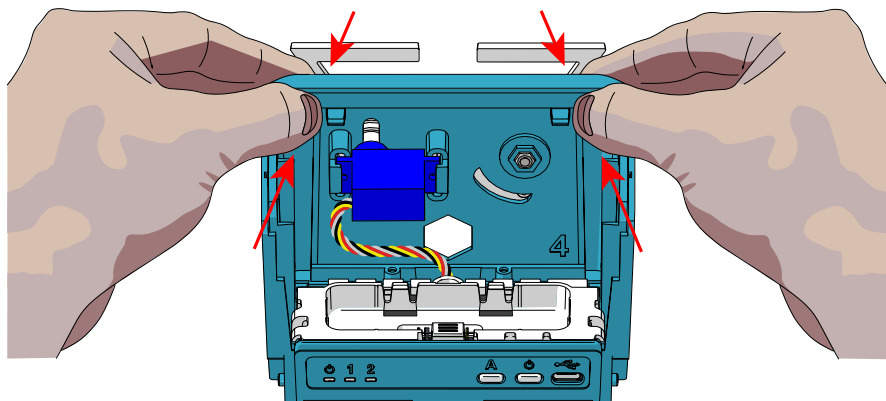
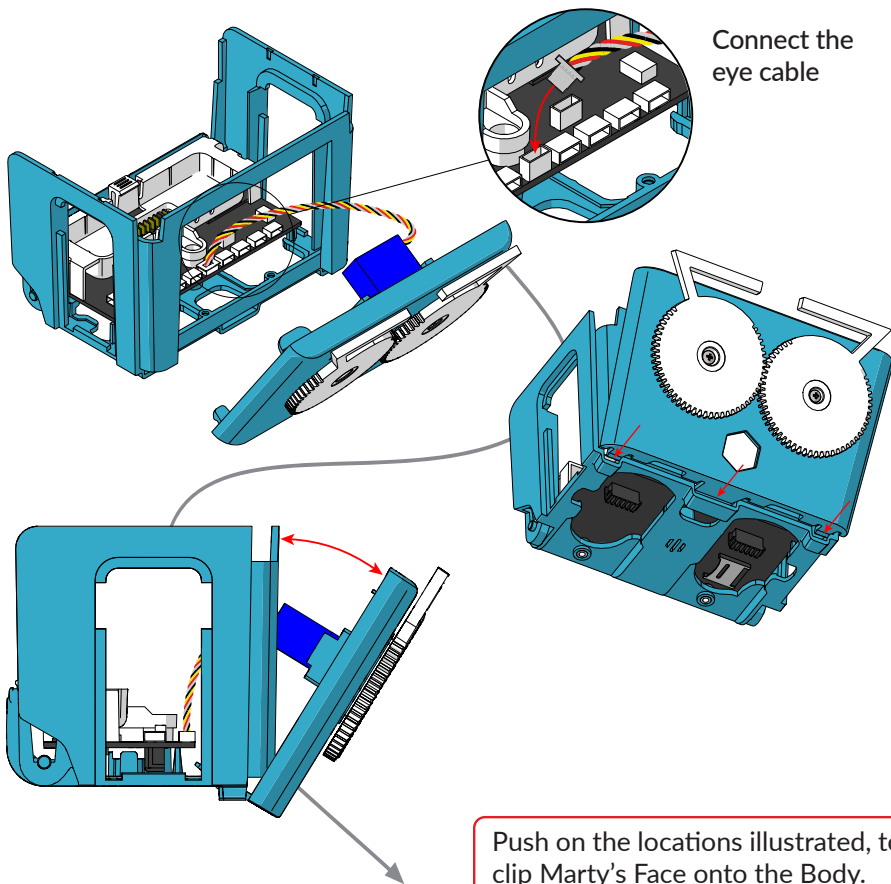



33



x 1



x 1

ATTACH **RIGHT** LEG TO THE BODY

**RIGHT  
LEG**



Attached the leg as illustrated below. Pay attention to the position of the cable to highlight orientation.

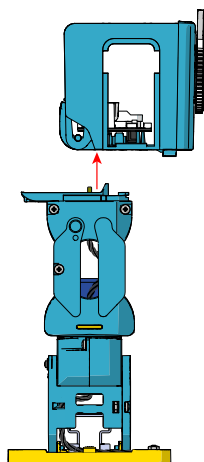

Step 1

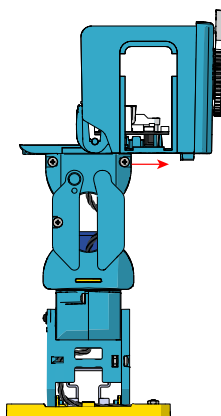

Step 2

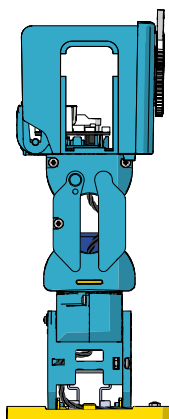

Step 3

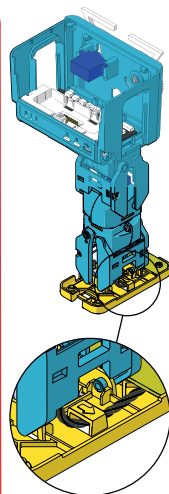

34



x 1



x 1

ATTACH **LEFT** LEG TO THE BODY

**LEFT  
LEG**



Attached the leg as illustrated below. Pay attention to the position of the cable to highlight orientation.

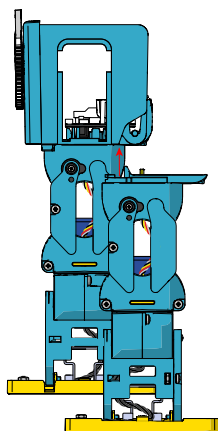

Step 1

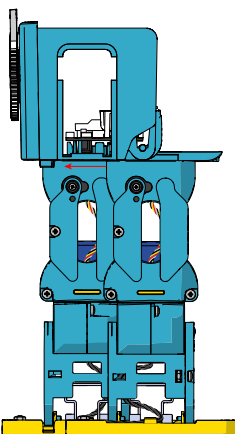

Step 2

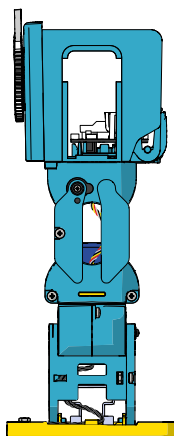

Step 3

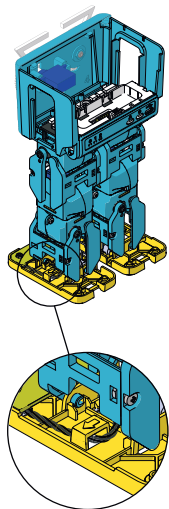

35

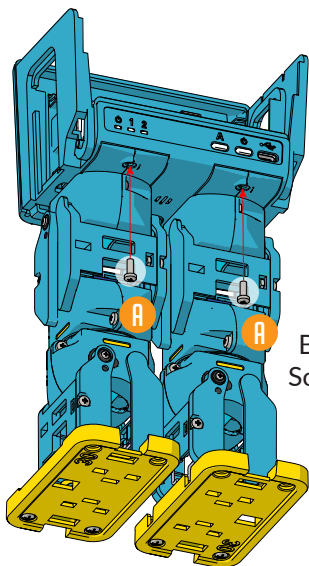

Body  
Screw

36



CONNECT THE ARM CABLES

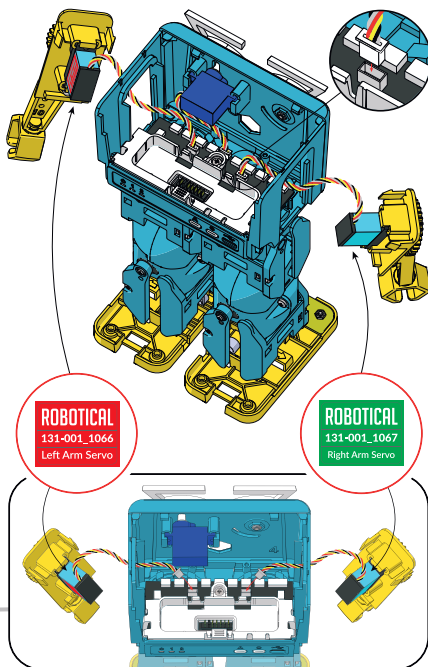

Clip the arms into the body

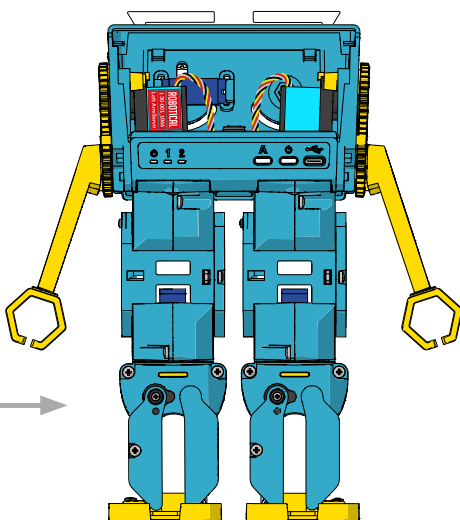
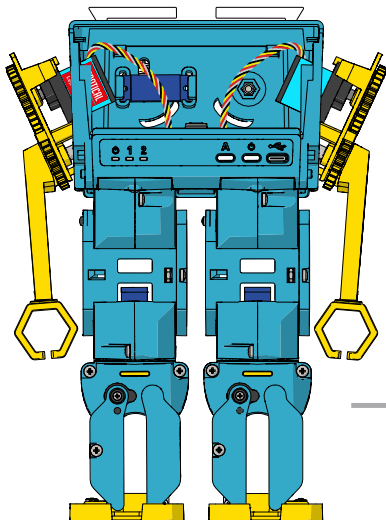

37



x 1



x 1

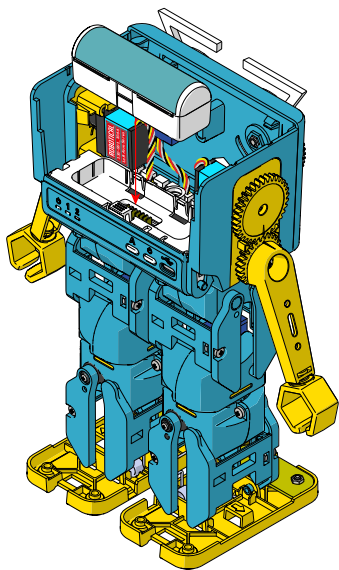

38



x 1



x 1

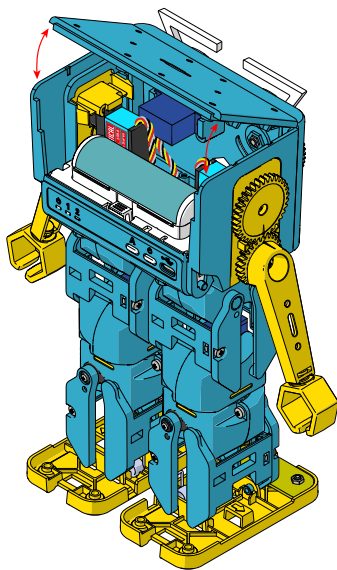

39



x 1



x 1

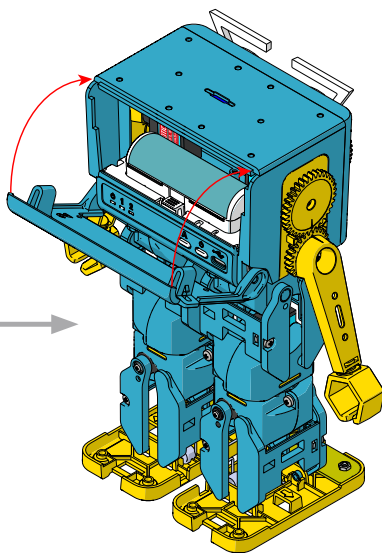
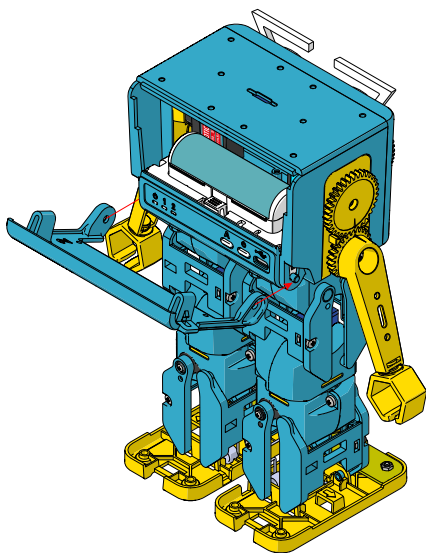

40



x 1 Sticker Sheet

Personalise your Marty!

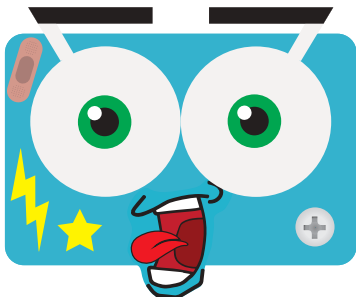
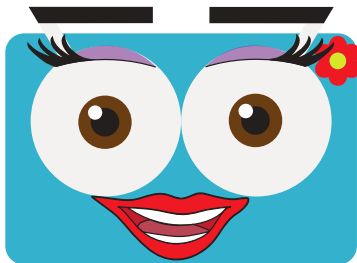
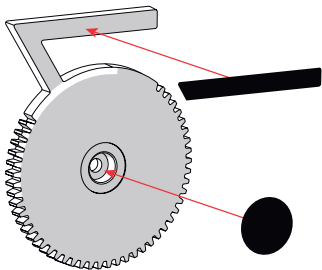

## NEXT STEPS

You have now finished building your Marty

To set-up your Marty and start coding, download the Marty the Robot V2 App and follow the on screen instructions

